

## NOM DU PROJET

## TYPE

## QTÉ



## POLA MONTÉ EN SURFACE BLANC STATIQUE – DIM TO WARM

Disponibles dans une variété d'intensité lumineuse et de méthodes d'installation, nos Solutions Linéaires Bas Voltage sont largement polyvalentes. Elles peuvent être utilisées pour leur fonctionnalité, comme éléments de design dans une pièce ou les deux.



<b>Degré Kelvin</b>	2700K, 3000K, 3500K, 4000K, Dim to Warm
<b>CRI*</b>	Jusqu'à 95, voir la Fiche Technique pour plus d'informations
<b>Flux Lumineux</b>	Jusqu'à 1400lm/pi, voir la Fiche Technique pour plus d'informations
<b>Lumen/Watt</b>	Jusqu'à 160lm/W, voir la Fiche Technique pour plus d'informations

\*Veuillez prendre note que cette information est basée sur une Source LED de 4000K.

### COULEUR DU PROFILÉ D'ALUMINIUM

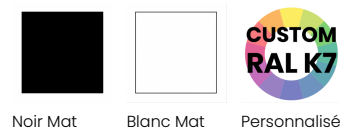

Noir Mat    Blanc Mat    Personnalisé

<b>Tension d'Entrée</b>	Transformateur à Distance; 100-277V
<b>Courant Continu</b>	24V
<b>Consommation</b>	Jusqu'à 8.78W/pi, voir la Fiche Technique pour plus d'informations
<b>Options de Contrôle</b>	0-10V, ELV Triac, Dali, Zigbee, DMX et plus
<b>Matériel</b>	Aluminium

\*Veuillez prendre note que cette information est basée sur une Source LED de 4000K.

### DEGRÉ KELVIN

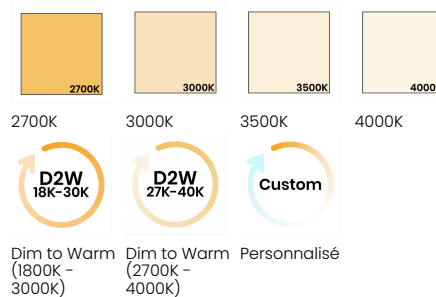

Dim to Warm (1800K - 3000K)    Dim to Warm (2700K - 4000K)    Personnalisé

# OPTIONS DE COMMANDE

## Pola Monté en Surface Blanc Statique – Dim to Warm

Code de Produit	Longueur	Couleur du Profilé d'Aluminium	Options de Lentille	Installation	Flux Lumineux
LWPL1-SMD	----	---	----	-----	-----
Transformateurs à commander séparément.	<b>CU</b> - Longueur Personnalisée 	<b>MBK</b> - Noir Mat	<b>CF</b> - Lentille Claire Givrée Clippée	<b>FRT</b> - Plafonnier Plat Rectangulaire	<b>HPC120</b> - 120lm/pi
Voir Transformateurs Compatibles pour plus de détails.	<b>CUPA</b> - Forme Personnalisée	<b>MWH</b> - Blanc Mat	<b>SBC</b> - Lentille Fumée Noire Clippée	<b>FSQ</b> - Plafonnier Plat Carré	<b>HPC290</b> - 290lm/pi
	Veuillez fournir les détails requis. Voir section suivante.	<b>CU</b> - Personnalisé 	<b>WF</b> - Lentille Blanche Givrée Clippée	<b>SMDBK</b> - Monté en Surface avec Support	<b>HPC420</b> - 420lm/pi
	Toute longueur supérieure à 2438mm   96po pourrait engendrer des frais supplémentaires.		<b>WO</b> - Lentille Blanche Opaline Clippée		<b>HPC700</b> - 700lm/pi
			<b>MBRCL</b> - Louver Rectangulaire Noir Mat		<b>HP900</b> - 900lm/pi
			<b>MWRCL</b> - Louver Rectangulaire Blanc Mat		<b>HE1150</b> - 1150lm/pi
			<b>NA</b> - Aucun		<b>HE1400</b> - 1400lm/pi
					<b>D2W480</b> - Dim to Warm 480lm/pi
Degré Kelvin	Alimentation Électrique	Sortie Électrique	Placement des Câbles Électriques	Protection IP	Méthode de Production
----	-----	-----	----	-----	---
<b>27K</b> - 2700K	<b>DC7IN</b> - Connecteur DC FT6 7po	<b>DC7IN</b> - Connecteur DC FT6 7po	<b>ICUS</b> - En-Dessous au Centre	<b>IP20</b> - IP20	<b>FAI</b> - Assemblé en Usine, Selon l'Incrément de la Source Lumineuse
<b>30K</b> - 3000K	<b>DC3FT</b> - Connecteur DC FT6 3pi	<b>DC3FT</b> - Connecteur DC FT6 3pi		<b>IP44</b> - IP44	<b>FAE</b> - Assemblé en Usine, Selon la Longueur Exacte Fournie
<b>35K</b> - 3500K	<b>FT43FT</b> - Câble FT4 3pi	<b>FT43FT</b> - Câble FT4 3pi			<b>FIE</b> - Assemblé au Chantier, Selon la Longueur Exacte Fournie
<b>40K</b> - 4000K	<b>TC3FT</b> - Câble Jumelé 3pi	<b>TC3FT</b> - Câble Jumelé 3pi			
<b>CU</b> - Personnalisé	<b>CUCBL</b> - Câble Personnalisé	<b>CUCBL</b> - Câble Personnalisé			
		<b>NA</b> - Aucun			
<b>D2W1</b> - Dim to Warm (1800K - 3000K)					
<b>D2W6</b> - Dim to Warm (2700K - 4000K)					
<b>CU</b> - Personnalisé					



## Dimensions

### Profilé

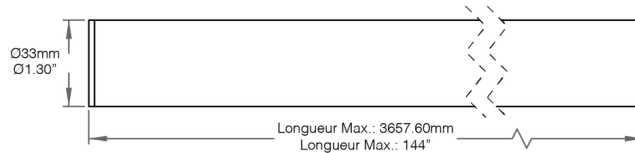
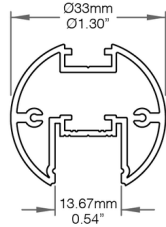

### Embouts

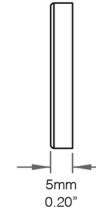

## Options d'Installation

### Support

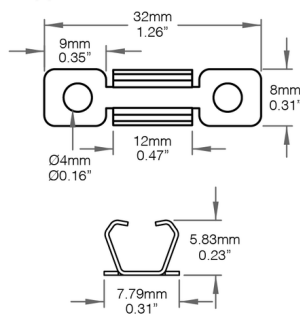

### Plafonnier Plat Rectangulaire

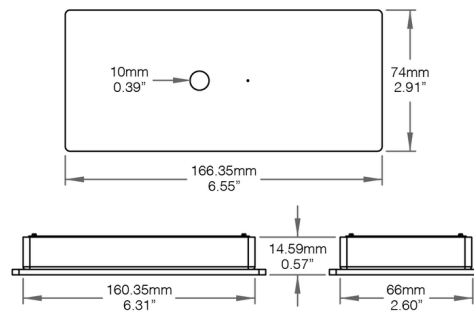

### Plafonnier Plat Carré

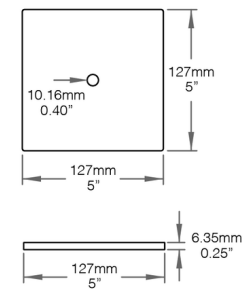

## Assemblage

### N'importe quelle Lentille ou Louver Support de Montage

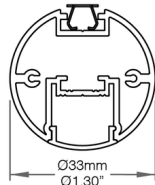

### N'importe quelle Lentille ou Louver Plafonnier Plat Rectangulaire

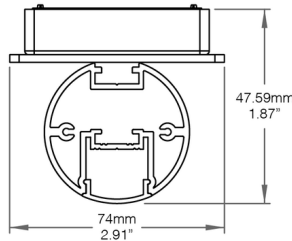

### N'importe quelle Lentille ou Louver Plafonnier Plat Carré

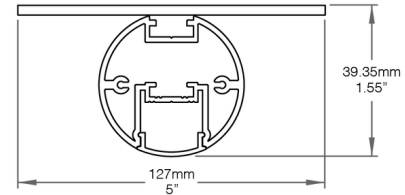

## Options de Lentilles



Lentille Claire Givrée – Lentille  
Blanche Givrée – Lentille Blanche  
Opaline

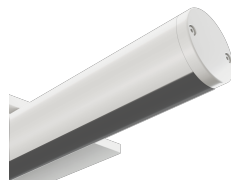

Lentille Fumée Noire



Louver Rectangulaire Noir Mat

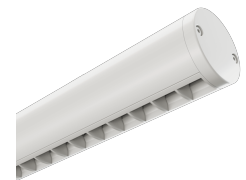

Louver Rectangulaire Blanc Mat

NOM DU PROJET

TYPE

QTÉ

## Informations Détaillées par Flux Lumineux (Consommation – Lumen/Watt – CRI)

<b>HPC120 - 120lm/pi</b>	0.91W/pi – 127lm/W – 95	<b>HP900 - 900lm/pi</b>	6.58W/pi – 95lm/W – 95
<b>HPC290 - 290lm/pi</b>	2.59W/pi – 110lm/W – 95	<b>HE1150 - 1150lm/pi</b>	7.31W/pi – 157lm/W – 90
<b>HPC420 - 420lm/pi</b>	3.51W/pi – 115lm/W – 95	<b>HE1400 - 1400lm/pi</b>	8.78W/pi – 160lm/W – 90
<b>HPC700 - 700lm/pi</b>	5.85W/pi – 120lm/W – 95	<b>D2W480 - Dim to Warm 480lm/pi</b>	5.27W/pi – 92lm/W – 90

## Longueur Maximale par Transformateur et Flux Lumineux

	120lm/ft		290lm/ft		420lm/ft		700lm/ft		900lm/ft		1150lm/ft		1400lm/ft		Dim to Warm 480lm/ft	
	Max. Run in Feet	Max. Run in Metre	Max. Run in Feet	Max. Run in Metre	Max. Run in Feet	Max. Run in Metre	Max. Run in Feet	Max. Run in Metre	Max. Run in Feet	Max. Run in Metre	Max. Run in Feet	Max. Run in Metre	Max. Run in Feet	Max. Run in Metre	Max. Run in Feet	Max. Run in Metre
30W Driver	27.35ft	8.34m	9.66ft	2.95m	6.84ft	2.09m	4.28ft	1.31m	3.80ft	1.16m	3.42ft	1.05m	2.85ft	0.87m	4.75ft	1.45m
60W Driver	54.69ft	16.67m	19.3ft	5.89m	13.68ft	4.17m	8.55ft	2.61m	7.60ft	2.32m	6.84ft	2.09m	5.70ft	1.74m	9.50ft	2.90m
75W Driver	68.36ft	20.84m	24.13ft	7.36m	17.09ft	5.21m	10.69ft	3.26m	9.50ft	2.90m	8.55ft	2.61m	7.13ft	2.18m	11.87ft	3.62m
96W Driver	87.50ft	26.67m	30.89ft	9.42m	21.88ft	6.67m	13.68ft	4.17m	12.16ft	3.71m	10.94ft	3.34m	9.12ft	2.78m	15.19ft	4.63m

## Visibilité du LED



Louver Rectangulaire Blanc Mat



Louver Rectangulaire Noir Mat



Louver Rectangulaire Noir Mat avec PCB Noir 700lm/pi



Lentille Claire Givrée – Visible – Perte de Lumière: 8.5%



Lentille Fumée Noire – À Peine Visible – Perte de Lumière: 11%



Lentille Blanche Givrée – À Peine Visible – Perte de Lumière: 23.5%



Lentille Blanche Opaline – Diffusé – Perte de Lumière: 37.5%

## Câbles et Connecteurs



### Câble Jumelé

- Câble de construction régulier
- Aucun grade de protection particulier



### Câble FT4/CMR

- Utilisation en cloison sèche
- Câble ignifuge
- Type Riser



### Connecteur DC Blanc Statique / Dim to Warm

- Connecteur rapide FT6 / CMP pour plénums

#### Accessoires Disponibles (À commander séparément):

- CBL-FT6-18/3-BK-0002 39.37in | 1000mm Extension de Connecteur DC - Mâle à Femelle
- CBL-FT6-18/3-BK-0003 78.74in | 2000mm Extension de Connecteur DC - Mâle à Femelle
- CBL-FT6-18/3-BK-0004 118.11in | 3000mm Extension de Connecteur DC - Mâle à Femelle
- CBL-FT6-18/3-BK-0005 11.81in | 300mm Répartiteur de Connecteur DC - Mâle à 3 Femelles



### Connecteur DC FT6 IP67

- Connecteur rapide FT6 / CMP à 3 broches pour plénums
- Protection IP67

#### Accessoires Disponibles (À commander séparément):

- CBL-FT6-18/3-BK-0007 39.37in | 1000mm Extension de Connecteur DC - Mâle à Femelle
- CBL-FT6-18/3-BK-0008 78.74in | 2000mm Extension de Connecteur DC - Mâle à Femelle
- CBL-FT6-18/3-BK-0009 118.11in | 3000mm Extension de Connecteur DC - Mâle à Femelle
- CBL-FT6-18/3-BK-0006 11.81in | 300mm Répartiteur de Connecteur DC - Femelle à 3 Mâles

## Longueurs Nominales selon l'Incrément de la Source Lumineuse et Consommation

Longueur Nominale	120lm/pi		290lm/pi		420lm/pi		700lm/pi		900lm/pi		1150lm/pi		1400lm/pi		Dim to Warm 480lm/pi	
	Longueur Moyenne	Wattage	Longueur Moyenne	Wattage	Longueur Moyenne	Wattage	Longueur Moyenne	Wattage	Longueur Moyenne	Wattage	Longueur Moyenne	Wattage	Longueur Moyenne	Wattage	Longueur Moyenne	Wattage
12" 304.80mm	10.62" 269.54mm	0.75	10.62" 269.54mm	2.12	10.62" 269.54mm	2.88	10.63" 269.26mm	4.80	11.78" 298.76mm	6.03	10.63" 269.26mm	6	10.62" 269.22mm	7.20	10.62" 269.54mm	4.32
16" 406.40mm	15.54" 394.68mm	1.12	15.54" 394.68mm	3.19	15.54" 394.68mm	4.32	14.57" 369.26mm	6.72	15.74" 399.38mm	8.21	14.57" 369.26mm	8.41	15.54" 394.20mm	10.80	15.54" 394.68mm	6.48
20" 508.00mm	18" 457.25mm	1.31	18" 457.25mm	3.72	18" 457.25mm	5.04	18.51" 469.26mm	8.65	19.70" 500mm	10.38	18.51" 469.26mm	10.81	18.82" 477.52mm	13.20	18" 457.25mm	7.56
24" 609.60mm	22.92" 582.39mm	1.69	22.92" 582.39mm	4.78	22.92" 582.39mm	6.48	22.45" 569.26mm	10.57	23.66" 600.62mm	12.55	22.45" 569.26mm	13.21	23.74" 602.50mm	16.79	22.92" 582.39mm	9.72
28" 711.20mm	27.84" 707.53mm	2.06	27.84" 707.53mm	5.84	27.84" 707.53mm	7.92	26.39" 669.26mm	12.49	27.62" 701.24mm	14.72	26.39" 669.26mm	15.61	27.02" 685.82mm	19.19	27.84" 707.53mm	11.88
32" 812.80mm	30.30" 770.10mm	2.25	30.30" 770.10mm	6.37	30.30" 770.10mm	8.64	30.33" 769.26mm	14.41	31.98" 801.86mm	16.90	30.33" 769.26mm	18.01	31.94" 810.80mm	22.79	30.30" 770.10mm	12.96
36" 914.40mm	35.22" 895.24mm	2.62	35.22" 895.24mm	7.44	35.22" 895.24mm	10.08	34.27" 869.26mm	16.33	35.98" 913.66mm	19.31	34.27" 869.26mm	20.41	35.22" 894.12mm	25.19	35.22" 895.24mm	15.12
40" 1016.00mm	37.68" 957.81mm	2.81	37.68" 957.81mm	7.97	37.68" 957.81mm	10.80	38.21" 969.26mm	18.25	39.94" 1014.29mm	21.48	38.21" 969.26mm	22.82	38.50" 977.44mm	27.59	37.68" 957.81mm	16.20
44" 1117.60mm	42.60" 1082.95mm	3.19	42.60" 1082.95mm	9.03	42.60" 1082.95mm	12.24	42.15" 1069.26mm	20.17	43.90" 1114.90mm	23.66	42.15" 1069.26mm	25.22	43.42" 1102.42mm	31.19	42.60" 1082.95mm	18.35
48" 1219.20mm	47.52" 1208.09mm	3.56	47.52" 1208.09mm	10.09	47.52" 1208.09mm	13.68	46.09" 1169.26mm	22.10	47.86" 1215.52mm	25.63	46.09" 1169.26mm	27.62	46.70" 1185.74mm	33.59	47.52" 1208.09mm	20.51
52" 1320.80mm	49.98" 1270.66mm	3.75	49.98" 1270.66mm	10.62	49.98" 1270.66mm	14.40	52" 1319.26mm	24.98	51.92" 1316.14mm	28	52" 1319.26mm	31.22	51.62" 1310.72mm	37.19	49.98" 1270.66mm	21.59
56" 1422.40mm	54.90" 1395.80mm	4.12	54.90" 1395.80mm	11.68	54.90" 1395.80mm	15.84	55.94" 1419.26mm	26.90	55.78" 1416.76mm	30.17	55.94" 1419.26mm	33.62	54.90" 1394.04mm	39.59	54.90" 1395.80mm	23.75
60" 1524.00mm	59.82" 1520.94mm	4.50	59.82" 1520.94mm	12.75	59.82" 1520.94mm	17.27	59.98" 1519.26mm	28.82	59.74" 1517.38mm	32.35	59.98" 1519.26mm	36.03	59.82" 1519.02mm	43.19	59.82" 1520.94mm	25.91
64" 1625.60mm	62.28" 1583.51mm	4.69	62.28" 1583.51mm	13.28	62.28" 1583.51mm	17.99	63.82" 1619.26mm	30.74	63.70" 1618mm	34.52	63.82" 1619.26mm	38.43	63.10" 1602.34mm	45.59	62.28" 1583.51mm	26.99
68" 1727.20mm	67.20" 1708.65mm	5.06	67.20" 1708.65mm	14.34	67.20" 1708.65mm	19.43	67.76" 1719.26mm	32.66	67.66" 1718.62mm	36.69	67.76" 1719.26mm	40.83	66.38" 1685.66mm	47.99	67.20" 1708.65mm	29.15
72" 1828.80mm	69.66" 1771.22mm	5.25	69.66" 1771.22mm	14.87	69.66" 1771.22mm	20.15	71.70" 1819.26mm	34.58	71.62" 1819.24mm	38.86	71.70" 1819.26mm	43.23	71.30" 1810.64mm	51.58	69.66" 1771.22mm	30.23
76" 1930.40mm	74.58" 1896.36mm	5.62	74.58" 1896.36mm	15.93	74.58" 1896.36mm	21.59	75.64" 1919.26mm	36.51	75.58" 1919.86mm	41.04	75.64" 1919.26mm	45.63	74.58" 1893.96mm	53.98	74.58" 1896.36mm	32.39
80" 2032.00mm	79.50" 2021.50mm	6	79.50" 2021.50mm	16.99	79.50" 2021.50mm	23.03	79.58" 2019.26mm	38.43	79.98" 2018.66mm	43.45	79.58" 2019.26mm	48.03	79.50" 2018.94mm	57.58	79.50" 2021.50mm	34.55
84" 2133.60mm	81.96" 2084.07mm	6.19	81.96" 2084.07mm	17.53	81.96" 2084.07mm	23.75	83.52" 2119.26mm	40.35	83.94" 2132.28mm	45.62	83.52" 2119.26mm	50.44	82.78" 2102.28mm	59.98	81.96" 2084.07mm	35.63
88" 2235.20mm	86.88" 2209.21mm	6.56	86.88" 2209.21mm	18.59	86.88" 2209.21mm	25.19	87.46" 2219.26mm	42.27	87.90" 2232.90mm	47.80	87.46" 2219.26mm	52.84	87.70" 2227.24mm	63.58	86.88" 2209.21mm	37.79
92" 2336.80mm	91.80" 2334.35mm	6.94	91.80" 2334.35mm	19.65	91.80" 2334.35mm	26.63	91.40" 2319.26mm	44.19	91.86" 2333.52mm	49.97	91.40" 2319.26mm	55.24	90.98" 2310.58mm	65.98	91.80" 2334.35mm	39.95
96" 2438.40mm	94.26" 2396.92mm	7.12	94.26" 2396.92mm	20.18	94.26" 2396.92mm	27.35	95.34" 2419.26mm	46.11	95.82" 2434.14mm	52.14	95.34" 2419.26mm	57.64	95.90" 2435.54mm	69.58	94.26" 2396.92mm	41.03
100" 2540.00mm	99.18" 2522.06mm	7.50	99.18" 2522.06mm	21.24	99.18" 2522.06mm	28.79	99.28" 2519.26mm	48.03	99.78" 2534.78mm	54.31	99.28" 2519.26mm	60.04	99.18" 2518.86mm	71.98	99.18" 2522.06mm	43.19
104" 2641.60mm	101.64" 2584.63mm	7.69	101.64" 2584.63mm	21.77	101.64" 2584.63mm	29.51	103.22" 2619.26mm	49.96	103.74" 2635.38mm	56.49	103.22" 2619.26mm	62.44	102.46" 2602.18mm	74.38	101.64" 2584.63mm	44.27
108" 2743.20mm	106.56" 2709.77mm	8.06	106.56" 2709.77mm	22.84	106.56" 2709.77mm	30.95	107.16" 2719.26mm	51.88	107.70" 2736mm	58.66	107.16" 2719.26mm	64.85	107.38" 2727.16mm	77.98	106.56" 2709.77mm	46.43
112" 2844.80mm	111.48" 2834.91mm	8.43	111.48" 2834.91mm	23.90	111.48" 2834.91mm	32.39	111.0" 2819.26mm	53.80	111.66" 2836.62mm	60.83	111.0" 2819.26mm	67.25	110.66" 2810.48mm	80.38	111.48" 2834.91mm	48.59
116" 2946.40mm	113.94" 2897.48mm	8.62	113.94" 2897.48mm	24.43	113.94" 2897.48mm	33.11	115.04" 2919.26mm	55.72	115.62" 2937.24mm	63	115.04" 2919.26mm	69.65	115.58" 2935.46mm	83.97	113.94" 2897.48mm	49.66
120" 3048.00mm	118.86" 3022.62mm	9	118.86" 3022.62mm	25.49	118.86" 3022.62mm	34.55	118.98" 3019.26mm	57.64	119.58" 3037.86mm	65.18	118.98" 3019.26mm	72.05	118.66" 3018.78mm	86.37	118.86" 3022.62mm	51.82
124" 3149.60mm	123.78" 3147.76mm	9.37	123.78" 3147.76mm	26.55	123.78" 3147.76mm	35.99	122.92" 3119.26mm	59.56	123.98" 3149.66mm	67.59	122.92" 3119.26mm	74.45	123.78" 3143.76mm	89.97	123.78" 3147.76mm	53.98
128" 3251.20mm	128.24" 3210.33mm	9.56	128.24" 3210.33mm	27.09	128.24" 3210.33mm	36.71	126.96" 3219.26mm	61.48	127.94" 3250.29mm	69.76	126.96" 3219.26mm	76.85	127.06" 3227.08mm	92.37	128.24" 3210.33mm	55.06
132" 3352.80mm	131.16" 3335.47mm	9.93	131.16" 3335.47mm	28.15	131.16" 3335.47mm	38.15	130.80" 3319.26mm	63.41	131.90" 3350.90mm	71.93	130.80" 3319.26mm	79.26	131.98" 3352.06mm	95.97	131.16" 3335.47mm	57.22
136" 3454.40mm	133.62" 3398.04mm	10.12	133.62" 3398.04mm	28.68	133.62" 3398.04mm	38.87	134.74" 3419.26mm	65.33	135.86" 3451.52mm	74.11	134.74" 3419.26mm	81.66	135.26" 3435.38mm	98.37	133.62" 3398.04mm	58.30
140" 3556.00mm	138.54" 3523.18mm	10.50	138.54" 3523.18mm	29.74	138.54" 3523.18mm	40.31	138.68" 3523.18mm	67.25	139.82" 3552.16mm	76.28	138.68" 3523.18mm	84.06	138.54" 3518.70mm	100.77	138.54" 3523.18mm	60.46
144" 3657.60mm	143.46" 3648.32mm	10.87	143.46" 3648.32mm	30.80	143.46" 3648.32mm	41.75	142.62" 3619.26mm	69.17	143.78" 3652.78mm	78.45	142.62" 3619.26mm	86.46	143.46" 3643.68mm	104.37	143.46" 3648.32mm	62.62

À titre indicatif seulement. Les mesures finales varieront légèrement en fonction des options choisies. Si une Sortie Électrique est requise, ajoutez 0.50po | 12.50mm à la mesure de Longueur Moyenne. Pour plus de longueurs, voir [Longueurs Détaillées et Consommation par Flux Lumineux](#).

## Kit d'Installation Optionnel pour Connexions Bas Voltage - Commander Séparément

### Boîte de Jonction - JBX-20

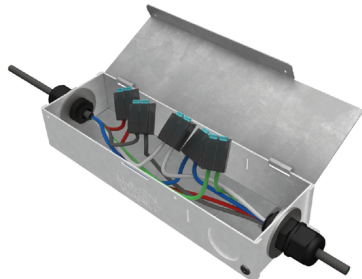

Deux grandeurs et plusieurs accessoires disponibles

Permet de faire des raccords électrique en toute sécurité

Peut contenir un transformateur

Fait d'aluminium



[Fiche Technique Boîte de Jonction](#)















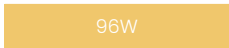
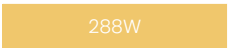



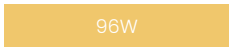

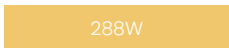
NOM DU PROJET

TYPE

QTÉ

## Transformateurs Compatibles

Objet	Caractéristiques	Téléchargements	
<b>Transformateurs Non-Dimmables</b>  	<ul style="list-style-type: none"> <li>- Listé UL</li> <li>- Tension d'entrée universelle, gamme complète</li> <li>- Protection IP66, adapté à une utilisation extérieure</li> <li>- Sortie à tension constante 24V, Class2</li> </ul>	   	
<b>Transformateurs Dimmables Cinq-en-Un</b>  	<ul style="list-style-type: none"> <li>- Listé UL</li> <li>- Tension d'entrée universelle: 100 - 277VAC</li> <li>- Protection IP67, adapté pour une utilisation extérieure</li> <li>- Phase directe, Phase inverse, ELV, 0-10V, 1-10V</li> </ul>	    	
<b>Transformateur Lutron</b>  	<ul style="list-style-type: none"> <li>- Listé UL</li> <li>- Tension d'entrée universelle: 120-277VAC</li> <li>- Sortie à tension constante 24V, Class2</li> <li>- Gradation continue jusqu'à 0.1%</li> </ul>		
<b>Transformateurs DMX/Zigbee</b>  	<ul style="list-style-type: none"> <li>- Tension d'entrée universelle: 100-277VAC</li> <li>- Protection IP20, adapté à une utilisation intérieur</li> <li>- Sortie à tension constante 24V, Class2</li> <li>- Compatible avec les contrôleurs Lumen Warm</li> </ul>	  	

Aussi Disponible

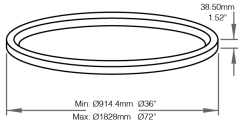

Cercio

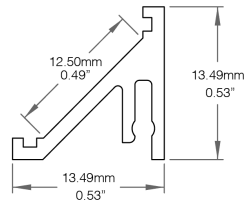

Connor

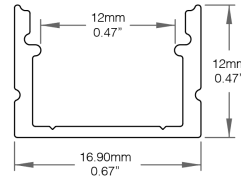

Doby

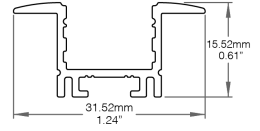

Jaxson

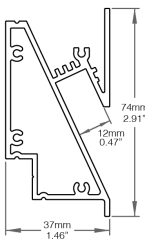

Myla

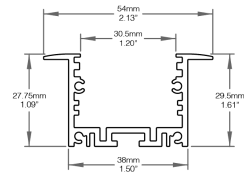

Palazzo Master

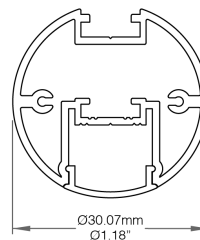

Pola

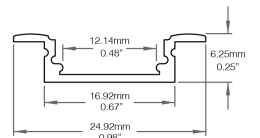

Robertha

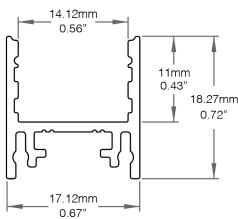

Rocco

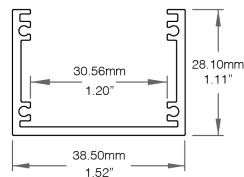

Venga Slim

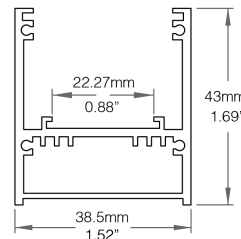

Venga

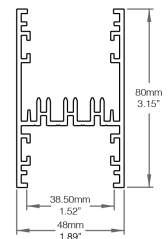

Venga Up & Down