

PROJECT NAME

TYPE

QTY



# QUICKSHIP DOBY STATIC WHITE

Available in a variety of light intensity and application methods, our Low Voltage Linear Solutions are widely versatile. They can be used either for their functionality, as design elements in a room or both.

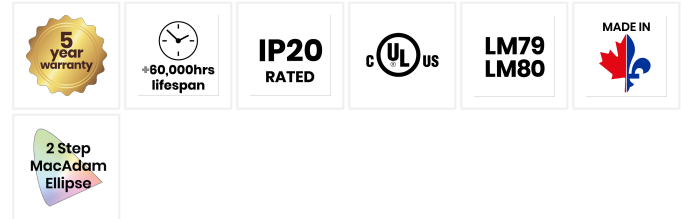

<b>Colour Temperature</b>	3000K, 3500K
<b>CRI*</b>	Up to 95, see Spec Sheet for more details
<b>Lumen Output</b>	290lm/ft, see Spec Sheet for more details
<b>Lumen/Watt</b>	110lm/W, see Spec Sheet for more details

\*Please note this information is based off a 4000K LED Source.

<b>Input Voltage</b>	Remote Driver; 100~277V
<b>Constant Voltage</b>	24V
<b>Consumption</b>	2.59W/ft, see Spec Sheet for more details
<b>Dimming Options</b>	0-10V and ELV Triac
<b>Material</b>	Aluminum

\*Please note this information is based off a 4000K LED Source.

## ALUMINUM PROFILE COLOUR



Clear Anodized

## COLOUR TEMPERATURE



3000K

3500K

PROJECT NAME

TYPE

QTY

# ORDERING OPTIONS

## Doby Static White

Product Code	Colour Temperature
4 feet length, anodized clear finish, white opal lens, surface mounted bracket installation, 290lm/ft, FT4 6 feet lead in, no lead out, lead placement extremities, IP20, factory assembled light source increment	30K / 35K
QS-LWDY-48IN-ACL-WO-SMDBK-HPC290-30K-FT46FT-NA-EXT-IP20-FAI	3000K
QS-LWDY-48IN-ACL-WO-SMDBK-HPC290-35K-FT46FT-NA-EXT-IP20-FAI	3500K

Maximum order size - **20pcs**

## Dimmable 5-in-1 Driver

Product Code	Wattage	Maximum Number of Fixtures
*Triac and 0-10V 5 in1 dimmable driver, constant voltage, 24VDC, Class II, IP67, junction box included	<b>30W / 60W / 96W</b>	<b>Qty</b>
LW-DIM-TRC-0-10V-100-277VAC-CV-24V-30W-IP67-JBX	30W	2 fixtures
LW-DIM-TRC-0-10V-100-277VAC-CV-24V-60W-IP67-JBX	60W	5 fixtures
LW-DIM-TRC-0-10V-100-277VAC-CV-24V-60W-IP67-JBX	96W	8 fixtures

\*Order only with Doby fixtures

## Production Method Details

Factory Assembled  
Using Light Source Increment  
(Max length: 96in | 2438mm)



Luminaire supplied fully assembled according to light source increment without exceeding specified length to optimize product's visual and eliminate dark end corners. See *Nominal Lengths and Wattage per Lumen Package* table for detailed lengths. The luminaire **cannot** be modified on site.

**\*Recommended option for all visible luminaires.**

## Nominal Lengths for Assembly Using Light Source Increment and Consumption

Nominal Length	290lm/ft	
	Actual Length	Wattage
48" 1219.20mm	47.29" 1202.63mm	10.09

PROJECT NAME

TYPE

QTY

### Maximum Run per Driver and Lumen Package

	290lm/ft	
	Max. Run In Feet	Max. Run In Metre
30W Driver	9.66ft	2.95m
60W Driver	19.31ft	5.89m
75W Driver	24.13ft	7.36m
96W Driver	30.89ft	9.42m

### Dimensions

#### Profile

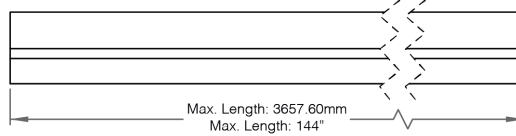
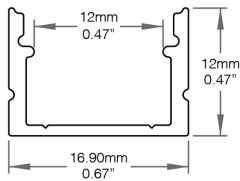

#### Endcaps

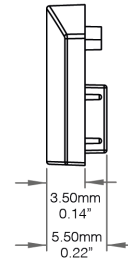

#### Bracket

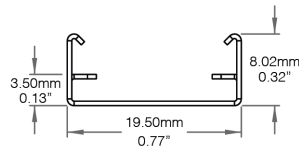
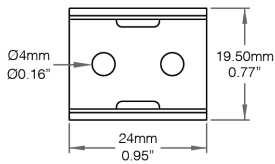

#### Assembly

Clear/White Frosted Lens  
White Opal Lens  
Smoked Black Lens  
Rectangular Louver

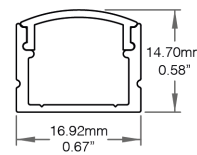

Clear/White Frosted Lens  
White Opal Lens  
Smoked Black Lens  
Rectangular Louver  
Surface Mounting Bracket

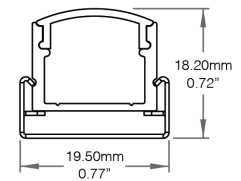

### Lens Options



White Opal Lens

### LED Visibility



White Opal Lens – Diffused – Light Loss: 37.5%

### Photometrics Data

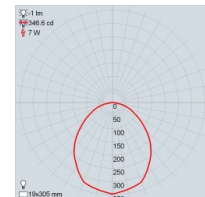

White Opal Lens – 1150lm/ft – 4000K

PROJECT NAME

TYPE

QTY

### Lead Placement

#### Extremities

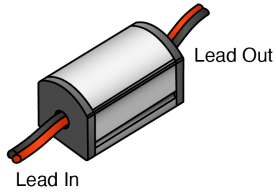

### Cables and Connectors

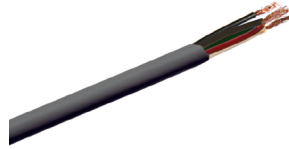

#### FT4/CMR Cable

- Drywall use
- Fire retardant cable
- Riser type

## Compatible Driver

Item	Specifications	Downloads
<p><b>Five-in-One Dimmable Drivers</b></p>  <p><b>LUMEN WARM</b></p>	<ul style="list-style-type: none"> <li>- UL Listed</li> <li>- Universal Input Voltage: 100-277VAC</li> <li>- IP67 rating, suitable for outdoor use</li> <li>- 24V Constant Voltage Output, Class2</li> <li>- Forward phase, Reverse phase, ELV, 0-10V, 1-10V</li> </ul>	<div style="display: flex; justify-content: space-around;"> <div style="background-color: #f1c40f; padding: 5px; border: 1px solid #ccc;">30W</div> <div style="background-color: #f1c40f; padding: 5px; border: 1px solid #ccc;">60W</div> </div> <div style="background-color: #f1c40f; padding: 5px; border: 1px solid #ccc; margin-top: 10px; width: fit-content; margin-left: auto; margin-right: auto;">96W</div>

**Project name**

**Type**

**QTY**

**LW-DIM-TRC-0-10V-100~277VAC-CV-24V-30W-IP67-JBX**  
**LW-DIM-TRC-0-10V-100~277VAC-CV-24V-60W-IP67-JBX**  
**LW-DIM-TRC-0-10V-100~277VAC-CV-24V-96W-IP67-JBX**



**Features**

- Output constant voltage
- UL, cUL Listed, Class 2 unit, Type HL rated, FCC
- Universal AC input: 100-277VAC
- Built-in active PFC function
- Power Factor: up to 0.98
- High efficiency: up to 80%
- Load: 10-100%
- Protection: Short Circuit / Over Loading / Over Temperature
- PWM output, does not change the colour index
- Full protection metal case, for dry, damp, wet location
- Flicker-free
- Dimming function:
  - 0-10V Dimming: 0-10V / 1-10V / Potentiometer / 10V PWM 4 in 1
- Phase dimming: Works with Forward phase/Leading edge, MLV and Reverse phase/Trailing edge, ELV, Triac dimmers
- Dimming range: 0-100%
- Suitable for LED lighting and moving sign applications

**Specification**

<b>Output</b>	DC Voltage	24V
	Rated Current	1.25A - 2.5A - 4A
	Rated Power	30W - 60W - 96W
	Voltage Tolerance	±0.5V
	Voltage Regulation	±0.5%
	Load Regulation	±1%
<b>Input</b>	Voltage Range	100-277VAC
	Frequency Range	47-63Hz
	Power Factor (Typ.) @Full Load	0.98 @120VAC 0.95 @277VAC
	THD (Typ.) @Full Load	<20%
	Efficiency (Typ.) @Full Load	79% @120VAC/80% @277VAC
	AC Current (Max.)	0.5A @100VAC - 1.3A @100VAC
	Inrush Current (Typ.)	7A, 50%, 420us @120VAC/12A, 50%, 480us @277VAC - 14A, 50%, 780us @120VAC/15A, 50%, 660us @277VAC - 20A, 50%, 1.6ms
Leakage Current	<0.50mA	
<b>Protection</b>	Short Circuit	Shut down O/P voltage, re-power on to recover after fault condition is removed
	Over Loading	≤120% shut down O/P voltage, re-power on to recover after fault condition is removed
	Over Temperature	100°C ±10°C shut down O/P voltage, automatically recovers after cooling
<b>Environment</b>	Working Temperature	-40°C ~ +60°C (See Derating Curve below)
	Working Humidity	20% ~ 90%RH, non-condensing
	Storage Temperature & Humidity	-40° ~ +80°C 10% ~ 95%RH
	Temperature Coefficient	±0.03%/°C (0°C ~ 50°C)
	Vibration	10 ~ 500Hz, 5G 10min./1 cycle, period for 60min. each along X, Y, Z axes
<b>Safety &amp; EMC</b>	Safety Standards	UL8750
	Withstand Voltage	I/P-O/P: 1.88KVAC
	Isolation Resistance	I/P-O/P: 100MΩ 500VDC 25°C 70%RH
	EMC Emission	FCC 47 CRF Part 15, Subpart B
<b>Others</b>	Net Weight	0.95kg - 1.1kg - 1.3kg
	Dimensions	165 x 94.5 x 40mm   6.50 x 3.72 x 1.57in - 188 x 94.5 x 40mm   7.40 x 3.72 x 1.57in - 220 x 94.5 x 40mm   8.66 x 3.72 x 1.57in (L x W x H)

All parameters if NOT specified otherwise are measured at 120VAC input, rated load and 25°C ambient temperature. To extend the driver's using life, please reduce the loading at lower input voltage.

**Project name**

**Type**

**QTY**

**LW-DIM-TRC-0-10V-100~277VAC-CV-24V-30W-IP67-JBX**  
**LW-DIM-TRC-0-10V-100~277VAC-CV-24V-60W-IP67-JBX**  
**LW-DIM-TRC-0-10V-100~277VAC-CV-24V-96W-IP67-JBX**

**Derating Curve**

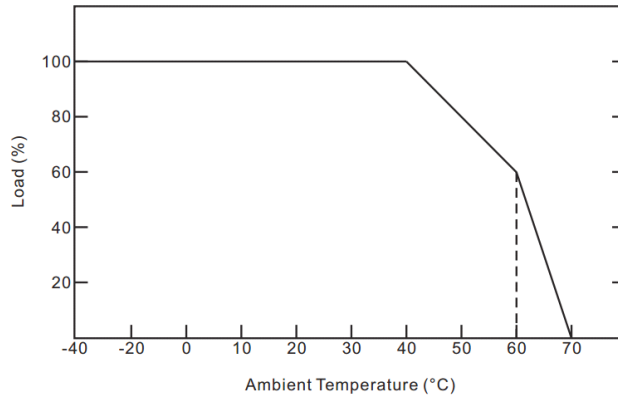

To extend their life, please refer to the Derating Curve and derate according to the temperature

**Dimensions**

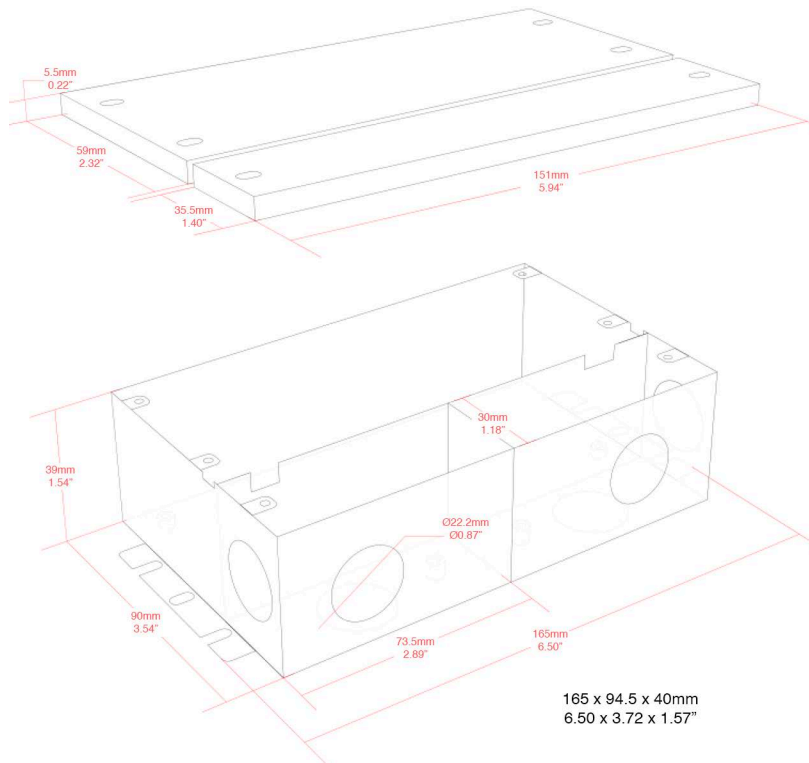

- Input Wire Black and White to be connected to AC L and N, Green wire is ground wire and goes ground.
- Output wire Red to LED Positive side (+), Black to LED Negative side (-).
- Dimming cable DIM (+) Purple to 0/1-10V dimmer signal (+), DIM (-) Grey to 0/1-10V dimmer signal (-).
- Please make sure these are connected correctly otherwise product will not function properly and could be damaged.