

1150lm/ft Static White LED Strip

Lumen Warm's high efficacy series is a high output and high efficiency range of LED strips. They offer 90+ CRI with outputs as high as 1400 lumens per foot and up to 160 lumens per watt.



Highlights

Colour Temperature	2700K, 3000K, 3500K, 4000K
CRI*	90+
Lumen Output	1148lm/ft 3768lm/m
Lumen/Watt	157lm/W
Driver	Remote Driver; 100~277V

Input Voltage	24VDC
Consumption	7.31W/ft 24W/m
Dimming Options	ELDR, DIM, DMX, DALI 2, DALI 2 + ATHENA NODE & LUTRON
Mounting	3M VHB premium quality double side tape
Applications	Dry or damp environments, high output light fixtures, millwork, cove, shelves, displays, handrails and much more.

*Please note this information is based off a 4000K LED Source.

*Please note this information is based off a 4000K LED Source.

Technical Information

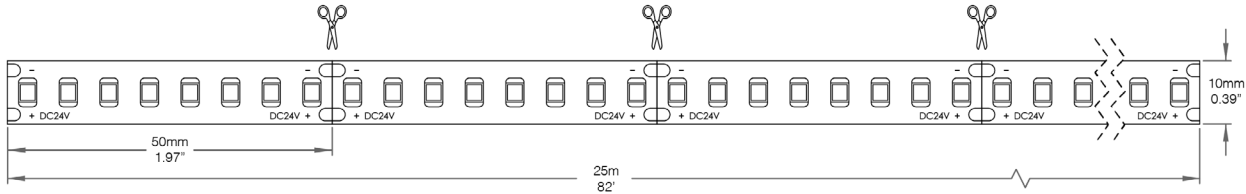

Ordering Options

Ex : LWHE1150-5m-27K-NA-NA

Product Code	Length	Colour Temperature	Lead In	Lead Out
LWHE1150				
	5m 5m 25m 25m CU Custom (0)	27K 2700K 30K 3000K 35K 3500K 40K 4000K CU Custom	DC7IN FT6 DC Quick Connect 7in DC3FT FT6 DC Quick Connect 3ft FT43FT FT4 Cable 3ft TC3FT Twin Cable 3ft CUCBL Custom Cable NA None (1)	DC7IN FT6 DC Quick Connect 7in DC3FT FT6 DC Quick Connect 3ft FT43FT FT4 Cable 3ft TC3FT Twin Cable 3ft CUCBL Custom Cable NA None (2)
	(0) Specify length & unit of measurement		(1) Refer to the following pages to select LED Strip Connectors, Junction Boxes & Wire Connectors.	(2) Refer to the following pages to select LED Strip Connectors, Junction Boxes & Wire Connectors.

Colour Temperature

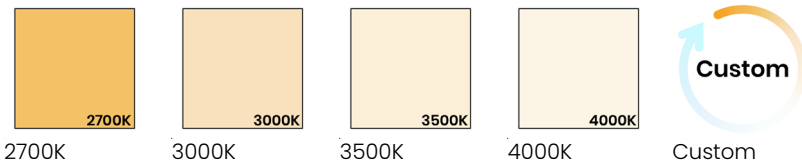

Light Loss Factor per Colour Temperature		Maximum Run per Driver	
4000K	0%	30W	3.42ft 1.05m
3500K	8%	60W	6.84ft 2.09m
3000K	17%	75W	8.55ft 2.61m
2700K	21%	96W	10.94ft 3.34m
2400K	24%	* Tape must be refeed every 30ft max to avoid voltage drop. *	
1800K	26%		

Technical Information

Parts Layout - LED Strip Connectors

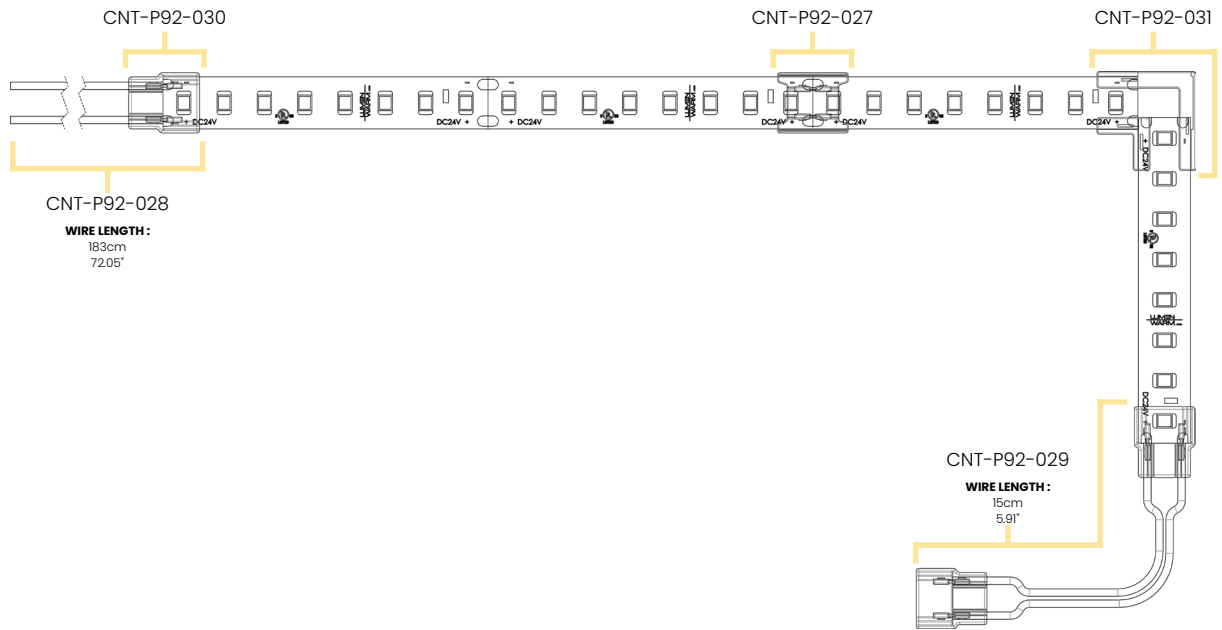

Dimensions

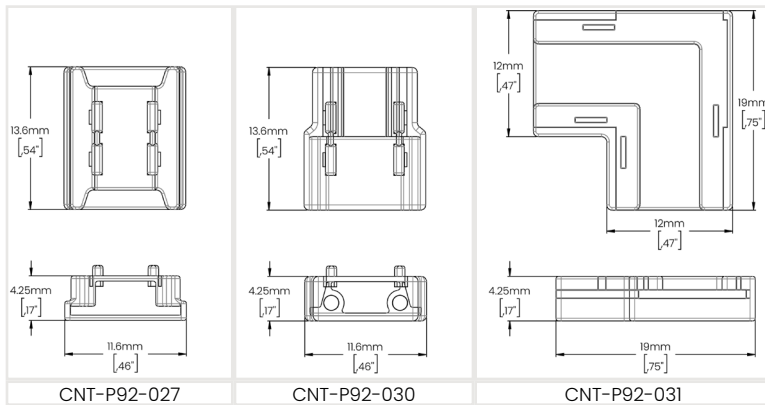

Ordering Options

LED Strip Connectors			
Code	CNT-P92-027	Quantity	
Code	CNT-P92-028	Quantity	
Code	CNT-P92-029	Quantity	
Code	CNT-P92-030	Quantity	
Code	CNT-P92-031	Quantity	

Workshop Drawing

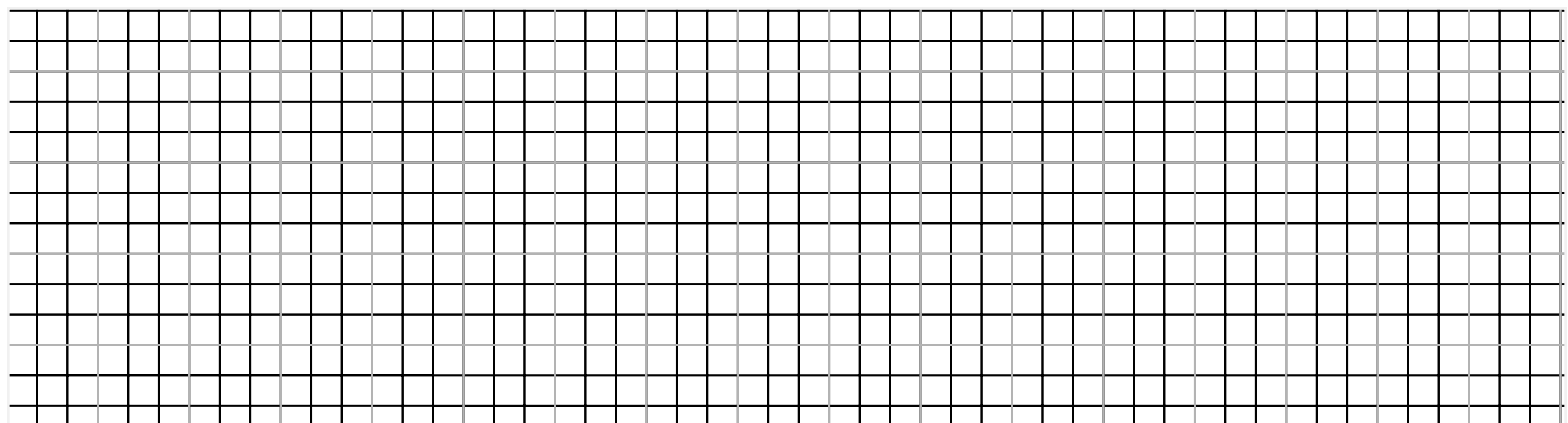

Technical Information

Parts Layout - Splice Boxes & Wire Connectors

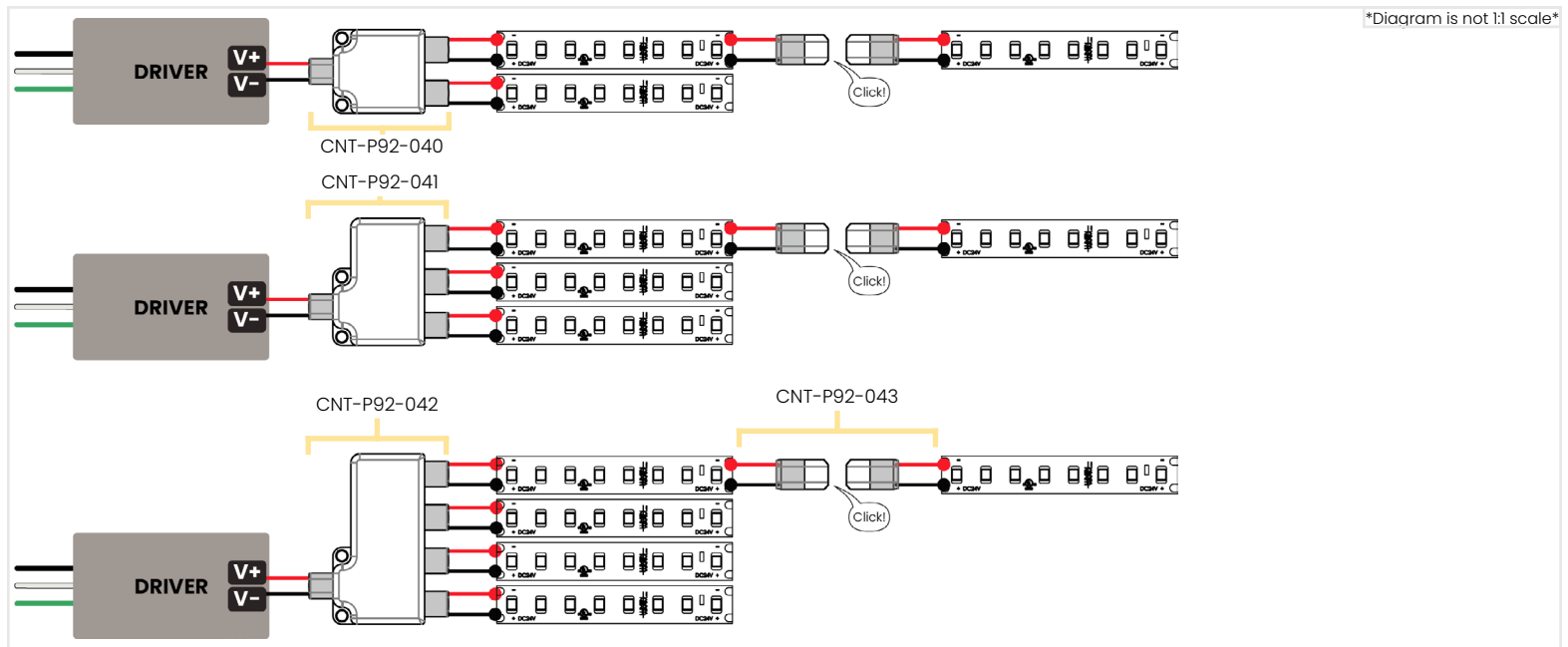

Dimensions

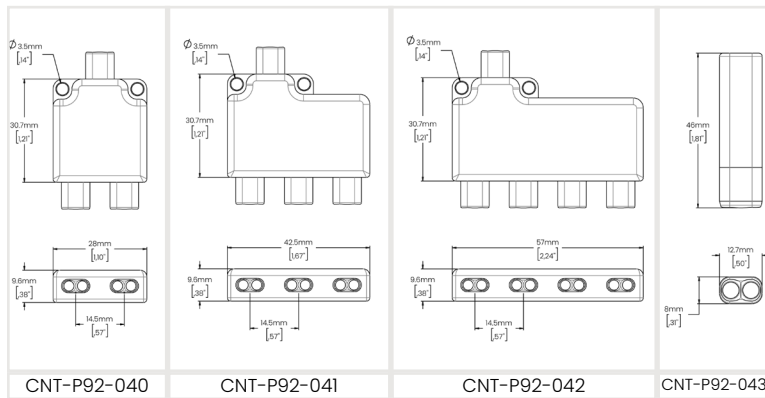

Specifications

Part	Specifications
CNT-P92-040	Rated Voltage: 12-48V
CNT-P92-041	Rated Current: 4A
CNT-P92-042	Working Environment Temperature: 14°F ~ 113°F / -10°C ~ 45°C
	Temperature Resistance: 221°F / 105°C
	Flame Retardant Grade: Complies with UL-94-V0

Ordering Options

Splice Boxes		
Code	CNT-P92-040	Quantity
Code	CNT-P92-041	Quantity
Code	CNT-P92-042	Quantity
Wire Connectors		
Code	CNT-P92-043	Quantity

Part	Specifications
CNT-P92-043	Rated Voltage: 300V
	Rated Current: 9A
	Working Environment Temperature: 14°F ~ 113°F / -10°C ~ 45°C
	Temperature Resistance: 221°F / 105°C
	Flame Retardant Grade: Complies with UL-94-V0
	Conductor Cross Section: 18 ~ 16AWG / 0.0012 ~ 0.0020in ²
	Max. Insulation Outer Diameter: Ø0.12in

Compatible Drivers

Non-Dimmable Drivers

	Specifications	
	UL Listed	IP66 rating, suitable for outdoor use
	Universal Input Voltage, full range	24V Constant Voltage Output, Class2
	Downloads (Click cells for linked documents)	
30W	96W	
60W	288W	

Five-in-One Dimmable Drivers

	Specifications	
	UL Listed	IP67 rating, suitable for indoor use
	Universal Input Voltage: 100-277VAC	24V Constant Voltage Output, Class2
	Downloads (Click cells for linked documents)	
30W	192W	
60W	288W	
96W		

DMX Drivers

	Specifications	
	Universal Input Voltage: 100-277VAC	24V Constant Voltage Output, Class2
	IP20 rating, suitable for indoor use	Compatible with Lumen Warm Controllers
	Downloads (Click cells for linked documents)	
100W		

Dali 2 Drivers + Lutron Athena Node

	Specifications	
	ENEC & UL approved	Range 100-277VAC
	Output constant voltage (NFC regulation)	Standby power consumption ≤0.5W
	Downloads (Click cells for linked documents)	
96W	Lutron Athena Node	

Dali 2 Drivers

	Specifications	
	ENEC & UL approved	Range 100-277VAC
	Output constant voltage (NFC regulation)	Standby power consumption ≤0.5W
	Downloads (Click cells for linked documents)	
96W		

Lutron Drivers

	Specifications	
	UL Listed	24V Constant Voltage Output, Class2
	Universal Input Voltage: 120-277VAC	Continuous dimming down to 0.1%
	Downloads (Click cells for linked documents)	
Hi-Lume Premier		

Compatible Products

Click on product names for more information.

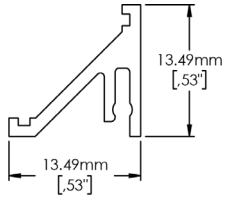

CONNOR

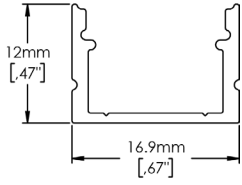

DOBY

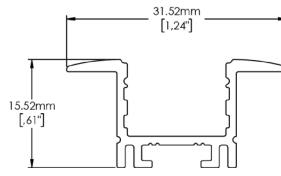

JAXSON

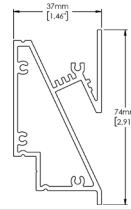

MYLA

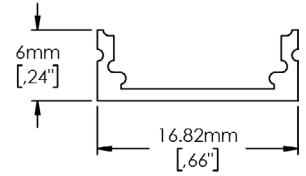

OLIVIA

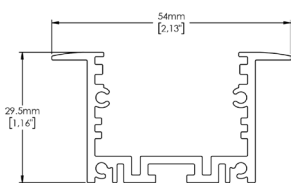

PALAZO MASTER

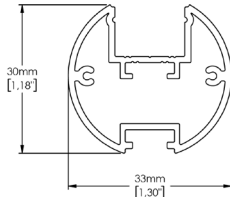

POLA

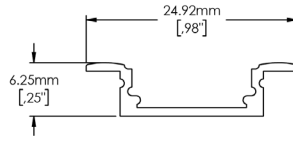

ROBERTHA

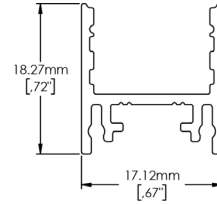

ROCCO

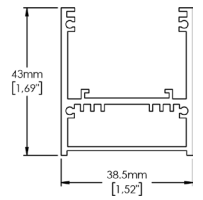

VENGA

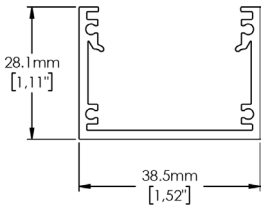

VENGA SLIM

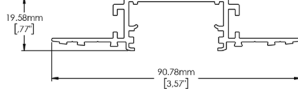

VENGA SLIM TRIMLESS

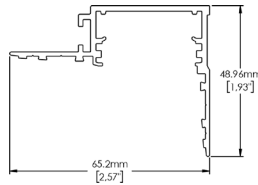

VENGA SLIM TRIMLESS PERIMETER

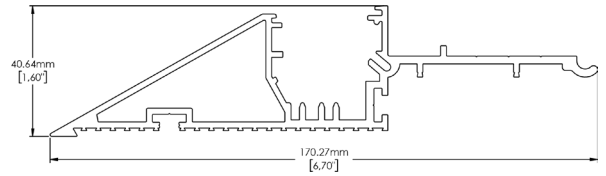

ARKALUX