

# 1400lm/ft Static White LED Strip

Lumen Warm's high efficacy series is a high output and high efficiency range of LED strips. They offer 90+ CRI with outputs as high as 1400 lumens per foot and up to 160 lumens per watt.

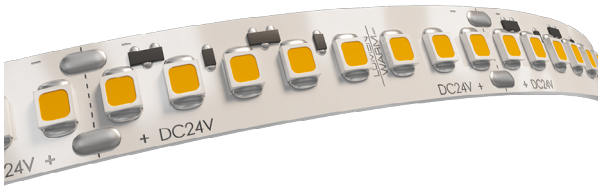

## Highlights

<b>Colour Temperature</b>	2700K, 3000K, 3500K, 4000K
<b>CRI*</b>	90+   2 Step MacAdam Ellipse
<b>Lumen Output</b>	1413lm/ft   4637lm/m
<b>Lumen/Watt</b>	161lm/W
<b>Driver</b>	Remote Driver; 100-277V

<b>Input Voltage</b>	24VDC
<b>Consumption</b>	8.78W/ft   28.8W/m
<b>Dimming Options</b>	ELDR, DIM, DMX, DALI 2, DALI 2 + ATHENA NODE & LUTRON
<b>Mounting</b>	3M VHB premium quality double side tape
<b>Applications</b>	Dry or damp environments, high output light fixtures, millwork, cove, shelves, displays, handrails and much more.

\*Please note this information is based off a 4000K LED Source.

\*Please note this information is based off a 4000K LED Source.

## Technical Information

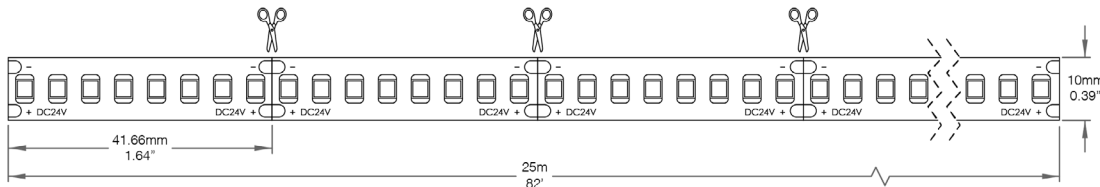

## Ordering Options

Ex : LWHE1400-5m-27K-NA-NA

Product Code	Length	Colour Temperature	Lead In	Lead Out
<b>LWHE1400</b>				
	<b>5m</b> 5m <b>25m</b> 25m <b>CU</b> Custom (0)	<b>27K</b> 2700K <b>30K</b> 3000K <b>35K</b> 3500K <b>40K</b> 4000K <b>CU</b> Custom	<b>DC7IN</b> FT6 DC Quick Connect 7in <b>DC3FT</b> FT6 DC Quick Connect 3ft <b>FT43FT</b> FT4 Cable 3ft <b>TC3FT</b> Twin Cable 3ft <b>CUCBL</b> Custom Cable <b>NA</b> None (1)	<b>DC7IN</b> FT6 DC Quick Connect 7in <b>DC3FT</b> FT6 DC Quick Connect 3ft <b>FT43FT</b> FT4 Cable 3ft <b>TC3FT</b> Twin Cable 3ft <b>CUCBL</b> Custom Cable <b>NA</b> None (2)
	(0) Specify length & unit of measurement		(1) Refer to the following pages to select LED Strip Connectors, Junction Boxes & Wire Connectors.	(2) Refer to the following pages to select LED Strip Connectors, Junction Boxes & Wire Connectors.

## Colour Temperature

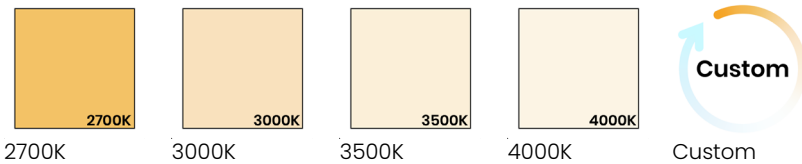

Light Loss Factor per Colour Temperature		Maximum Run per Driver	
<b>4000K</b>	0%	<b>30W</b>	2.85ft   0.87m
<b>3500K</b>	8%	<b>60W</b>	5.70ft   1.74m
<b>3000K</b>	17%	<b>75W</b>	7.13ft   2.18m
<b>2700K</b>	21%	<b>96W</b>	9.12ft   2.78m
<b>2400K</b>	24%	* Tape must be refeed every 30ft max to avoid voltage drop. *	
<b>1800K</b>	26%		

# Technical Information

## Parts Layout - LED Strip Connectors

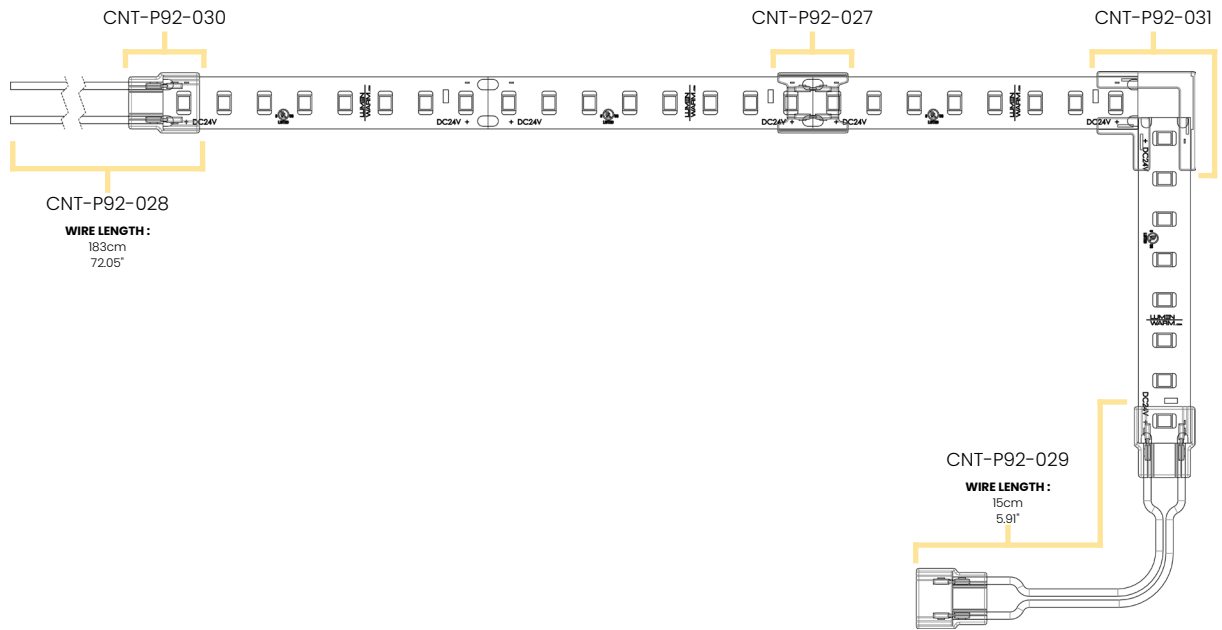

### Dimensions

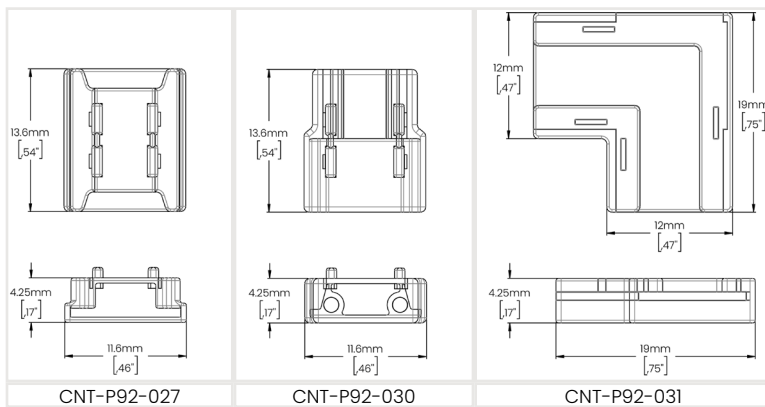

### Ordering Options

LED Strip Connectors			
Code	CNT-P92-027	Quantity	
Code	CNT-P92-028	Quantity	
Code	CNT-P92-029	Quantity	
Code	CNT-P92-030	Quantity	
Code	CNT-P92-031	Quantity	

### Workshop Drawing

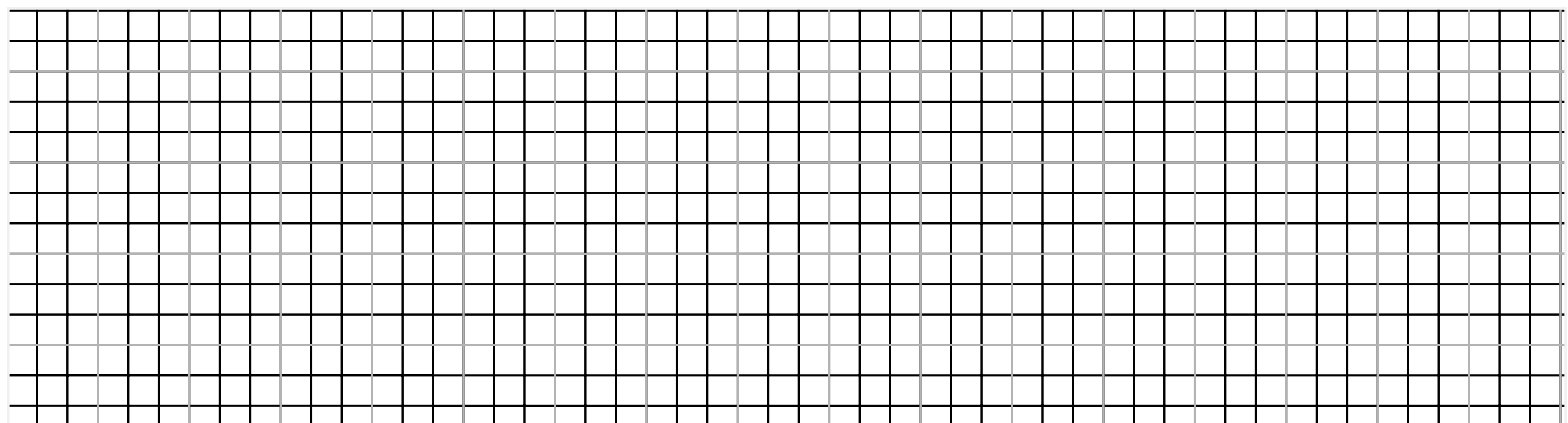

# Technical Information

## Parts Layout - Splice Boxes & Wire Connectors

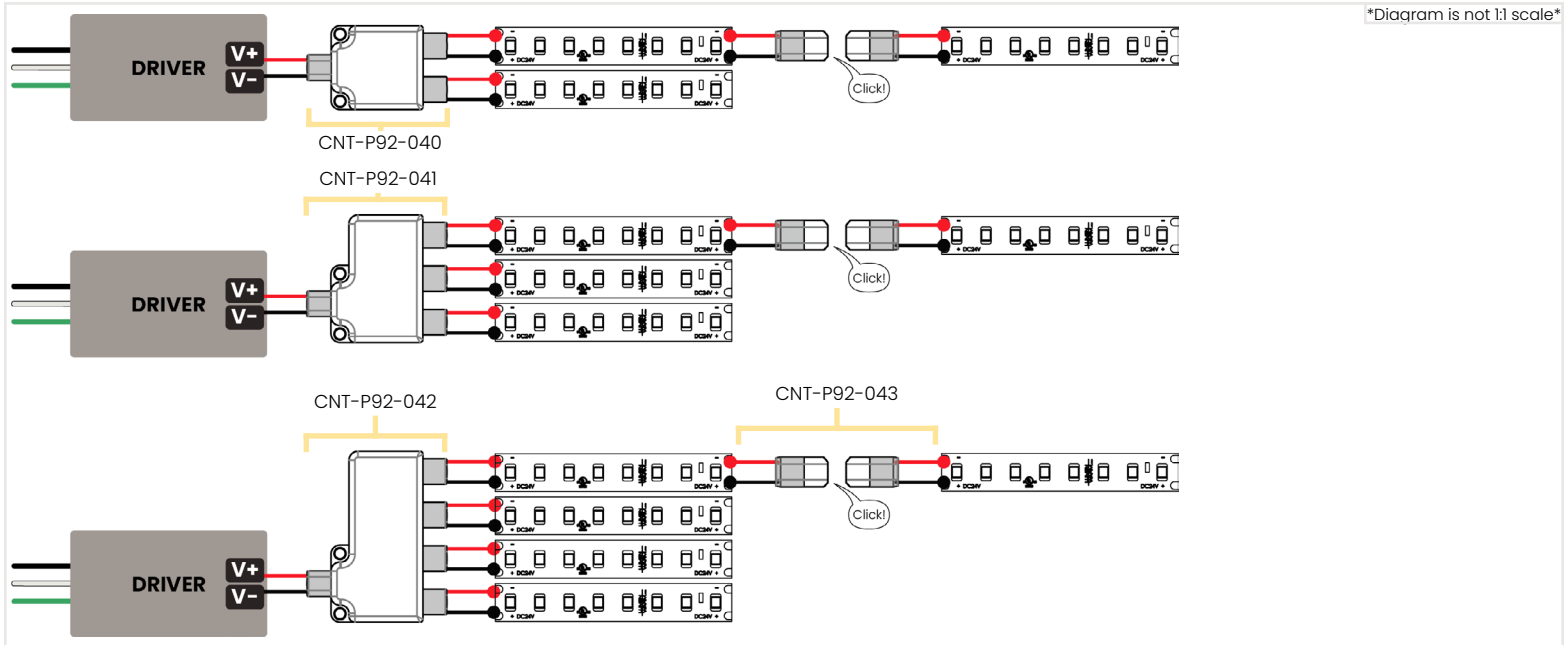

## Dimensions

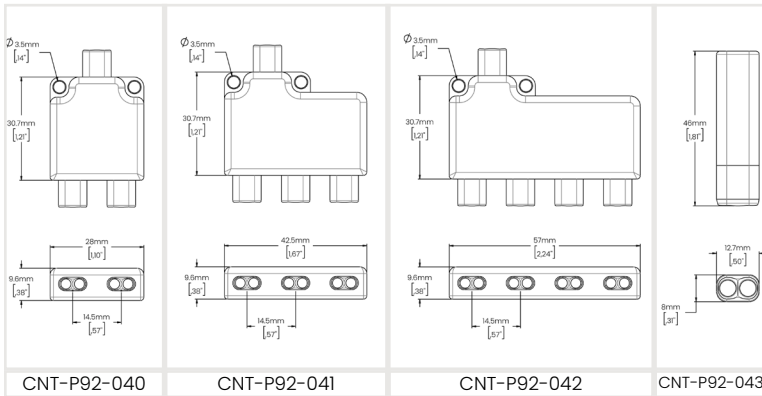

## Specifications

Part	Rated Voltage	Rated Current	Working Environment Temperature	Temperature Resistance	Flame Retardant Grade
CNT-P92-040	12-48V	4A	14°F ~ 113°F / -10°C ~ 45°C	221°F / 105°C	Complies with UL-94-V0
CNT-P92-041					
CNT-P92-042					

## Ordering Options

Splice Boxes		
Code	CNT-P92-040	Quantity
Code	CNT-P92-041	Quantity
Code	CNT-P92-042	Quantity
Wire Connectors		
Code	CNT-P92-043	Quantity

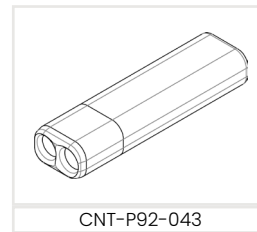

Rated Voltage	300V
Rated Current	9A
Working Environment Temperature	14°F ~ 113°F / -10°C ~ 45°C
Temperature Resistance	221°F / 105°C
Flame Retardant Grade	Complies with UL-94-V0
Conductor Cross Section	18 ~ 16AWG / 0.0012 ~ 0.0020in <sup>2</sup>
Max. Insulation Outer Diameter	Ø0.12in

## Compatible Drivers

### Non-Dimmable Drivers

	Specifications	
	UL Listed	IP66 rating, suitable for outdoor use
	Universal Input Voltage, full range	24V Constant Voltage Output, Class2
	Downloads (Click cells for linked documents)	
<b>30W</b>	<b>96W</b>	
<b>60W</b>	<b>288W</b>	

### Five-in-One Dimmable Drivers

	Specifications	
	UL Listed	IP67 rating, suitable for indoor use
	Universal Input Voltage: 100-277VAC	24V Constant Voltage Output, Class2
	Downloads (Click cells for linked documents)	
<b>30W</b>	<b>192W</b>	
<b>60W</b>	<b>288W</b>	
<b>96W</b>		

### DMX Drivers

	Specifications	
	Universal Input Voltage: 100-277VAC	24V Constant Voltage Output, Class2
	IP20 rating, suitable for indoor use	Compatible with Lumen Warm Controllers
	Downloads (Click cells for linked documents)	
<b>100W</b>		

### Dali 2 Drivers + Lutron Athena Node

	Specifications	
	ENEC & UL approved	Range 100-277VAC
	Output constant voltage (NFC regulation)	Standby power consumption ≤0.5W
	Downloads (Click cells for linked documents)	
<b>96W</b>	<b>Lutron Athena Node</b>	

### Dali 2 Drivers

	Specifications	
	ENEC & UL approved	Range 100-277VAC
	Output constant voltage (NFC regulation)	Standby power consumption ≤0.5W
	Downloads (Click cells for linked documents)	
<b>96W</b>		

### Lutron Drivers

	Specifications	
	UL Listed	24V Constant Voltage Output, Class2
	Universal Input Voltage: 120-277VAC	Continuous dimming down to 0.1%
	Downloads (Click cells for linked documents)	
<b>Hi-Lume Premier</b>		

## Compatible Products

Click on product names for more information.

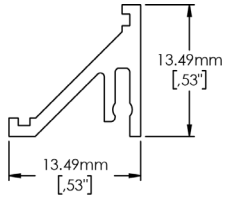

**CONNOR**

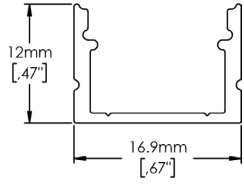

**DOBY**

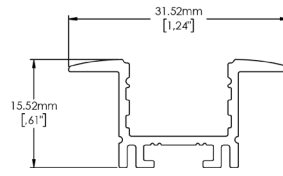

**JAXSON**

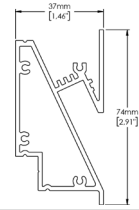

**MYLA**

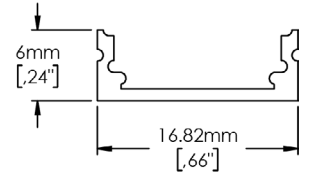

**OLIVIA**

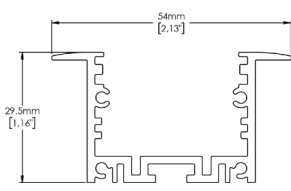

**PALAZO MASTER**

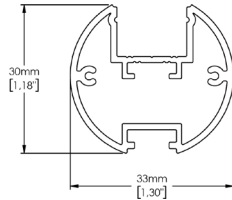

**POLA**

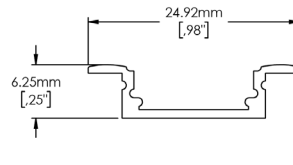

**ROBERTHA**

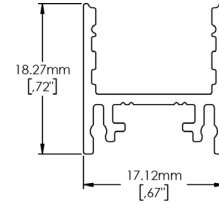

**ROCCO**

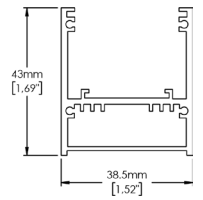

**VENGA**

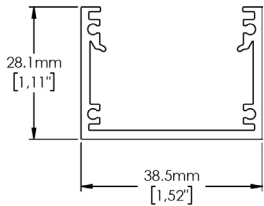

**VENGA SLIM**

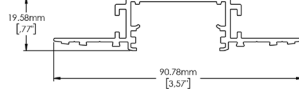

**VENGA SLIM TRIMLESS**

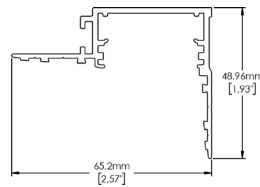

**VENGA SLIM TRIMLESS PERIMETER**

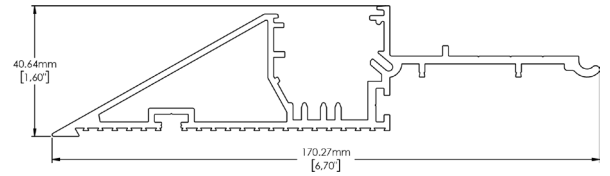

**ARKALUX**