

# 900lm/ft Static White LED Strip

Lumen Warm's high efficacy series is a high output and high efficiency range of LED strips. They offer 90+ CRI with outputs as high as 1400 lumens per foot and up to 160 lumens per watt.

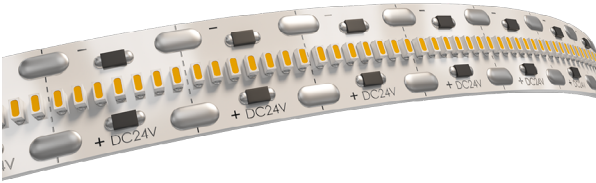

## Highlights

<b>Colour Temperature</b>	2700K, 3000K, 3500K, 4000K
<b>CRI*</b>	95+
<b>Lumen Output</b>	897lm/ft   2942lm/m
<b>Lumen/Watt</b>	95lm/W
<b>Driver</b>	Remote Driver; 100~277V

<b>Input Voltage</b>	24VDC
<b>Consumption</b>	6.58W/ft   21.6W/m
<b>Dimming Options</b>	ELDR, DIM, DMX, DALI 2, DALI 2 + ATHENA NODE & LUTRON
<b>Mounting</b>	3M VHB premium quality double side tape
<b>Applications</b>	Dry or damp environments, high output light fixtures, millwork, cove, shelves, displays, handrails and much more.

\*Please note this information is based off a 4000K LED Source.

\*Please note this information is based off a 4000K LED Source.

## Technical Information

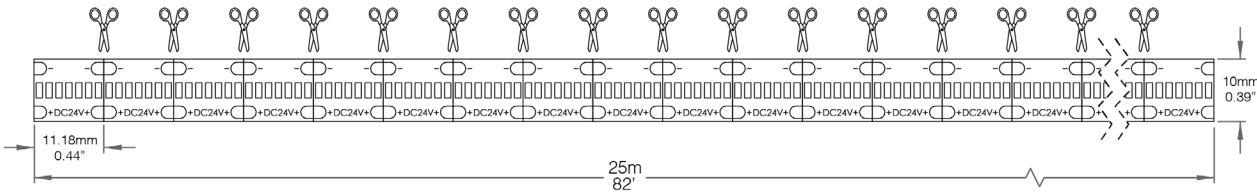

## Ordering Options

Ex : LWHP900-5m-27K-NA-NA

Product Code	Length	Colour Temperature	Lead In	Lead Out
<b>LWHP900</b>				
	5m 25m CU Custom (0)	27K 2700K 30K 3000K 35K 3500K 40K 4000K CU Custom	DC7IN FT6 DC Quick Connect 7in DC3FT FT6 DC Quick Connect 3ft FT43FT FT4 Cable 3ft TC3FT Twin Cable 3ft CUCBL Custom Cable NA None (1)	DC7IN FT6 DC Quick Connect 7in DC3FT FT6 DC Quick Connect 3ft FT43FT FT4 Cable 3ft TC3FT Twin Cable 3ft CUCBL Custom Cable NA None (2)
	(0) Specify length & unit of measurement		(1) Refer to the following pages to select LED Strip Connectors, Junction Boxes & Wire Connectors.	(2) Refer to the following pages to select LED Strip Connectors, Junction Boxes & Wire Connectors.

## Colour Temperature

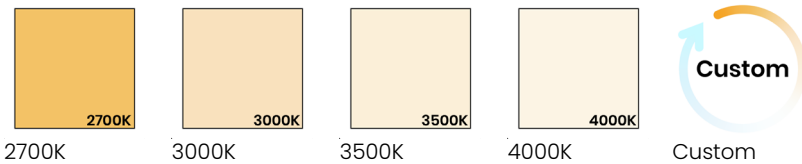

Light Loss Factor per Colour Temperature		Maximum Run per Driver	
4000K	0%	30W	3.80ft   1.16m
3500K	8%	60W	7.60ft   2.32m
3000K	17%	75W	9.50ft   2.90m
2700K	21%	96W	12.16ft   3.71m
2400K	24%	* Tape must be refeed every 30ft max to avoid voltage drop. *	
1800K	28%		

# Technical Information

## Parts Layout - LED Strip Connectors

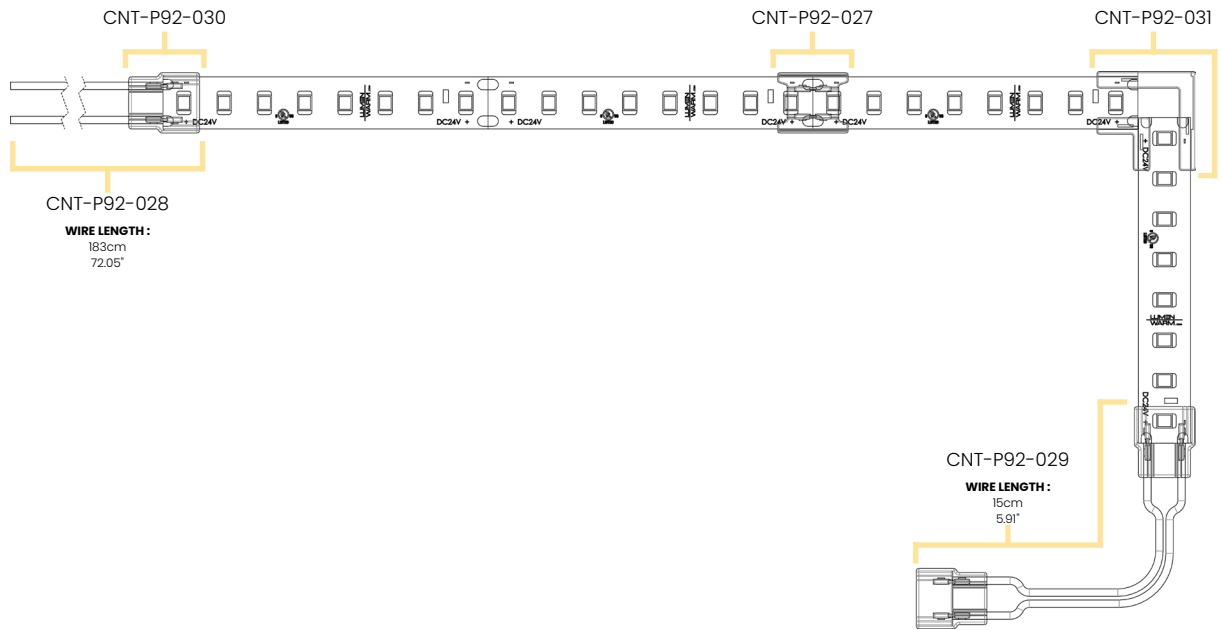

### Dimensions

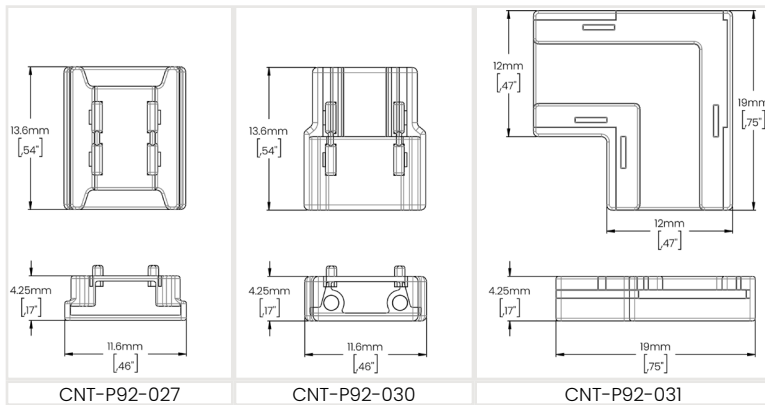

### Ordering Options

LED Strip Connectors			
Code	CNT-P92-027	Quantity	
Code	CNT-P92-028	Quantity	
Code	CNT-P92-029	Quantity	
Code	CNT-P92-030	Quantity	
Code	CNT-P92-031	Quantity	

### Workshop Drawing

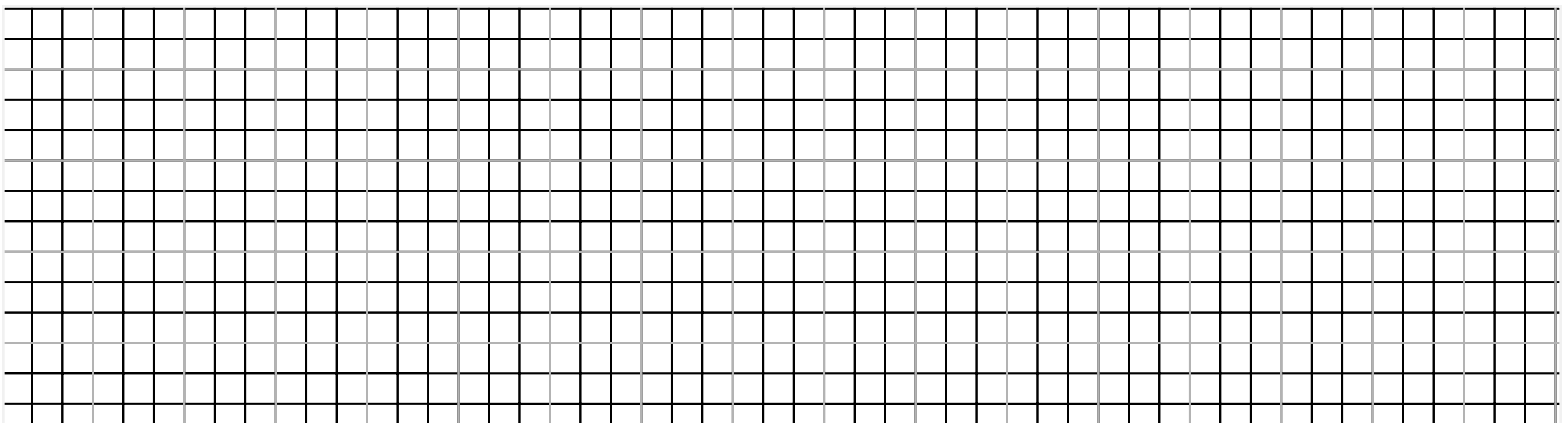

# Technical Information

## Parts Layout - Splice Boxes & Wire Connectors

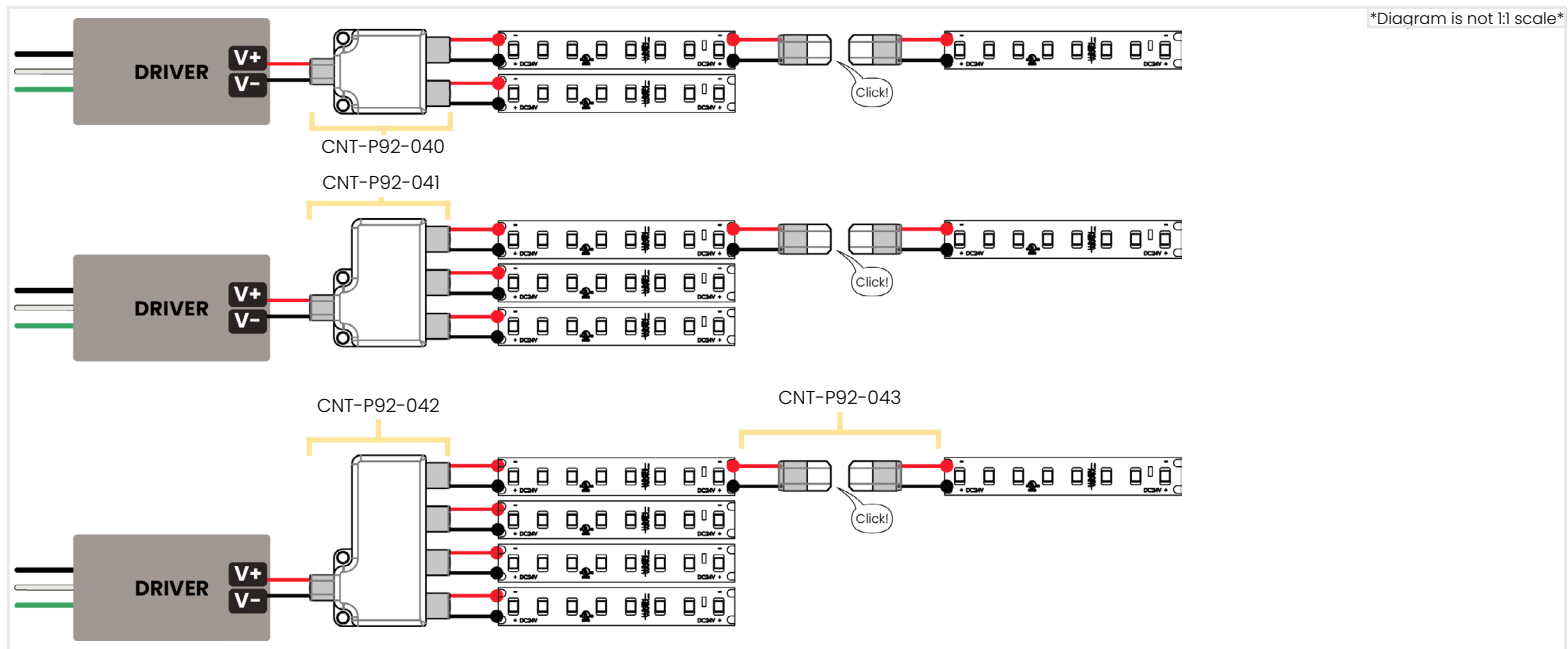

## Dimensions

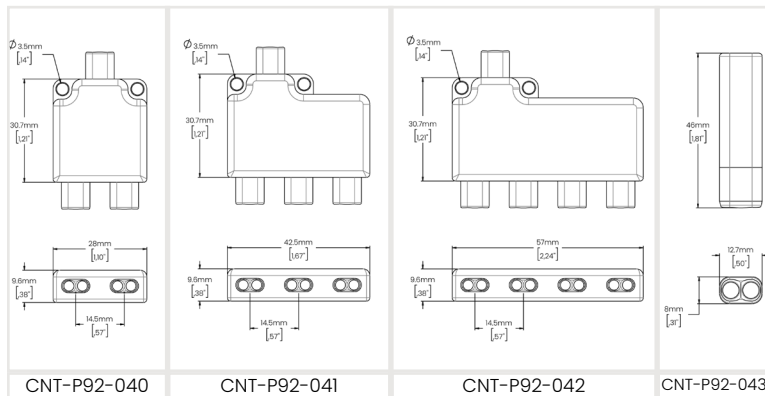

## Specifications

Part	Rated Voltage	Rated Current	Working Environment Temperature	Temperature Resistance	Flame Retardant Grade
CNT-P92-040	12-48V	4A	14°F ~ 113°F / -10°C ~ 45°C	221°F / 105°C	Complies with UL-94-V0
CNT-P92-041					
CNT-P92-042					

## Ordering Options

### Splice Boxes

Code	Quantity
CNT-P92-040	
CNT-P92-041	
CNT-P92-042	

### Wire Connectors

Code	Quantity
CNT-P92-043	

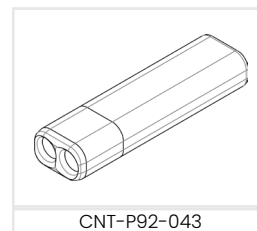

Part	Rated Voltage	Rated Current	Working Environment Temperature	Temperature Resistance	Flame Retardant Grade	Conductor Cross Section	Max. Insulation Outer Diameter
CNT-P92-043	300V	9A	14°F ~ 113°F / -10°C ~ 45°C	221°F / 105°C	Complies with UL-94-V0	18 ~ 16AWG / 0.0012 ~ 0.0020in <sup>2</sup>	Ø0.12in

## Compatible Drivers

### Non-Dimmable Drivers

	Specifications	
	UL Listed	IP66 rating, suitable for outdoor use
	Universal Input Voltage, full range	24V Constant Voltage Output, Class2
	Downloads (Click cells for linked documents)	
<b>30W</b>	<b>96W</b>	
<b>60W</b>	<b>288W</b>	

### Five-in-One Dimmable Drivers

	Specifications	
	UL Listed	IP67 rating, suitable for indoor use
	Universal Input Voltage: 100-277VAC	24V Constant Voltage Output, Class2
	Downloads (Click cells for linked documents)	
<b>30W</b>	<b>192W</b>	
<b>60W</b>	<b>288W</b>	
<b>96W</b>		

### DMX Drivers

	Specifications	
	Universal Input Voltage: 100-277VAC	24V Constant Voltage Output, Class2
	IP20 rating, suitable for indoor use	Compatible with Lumen Warm Controllers
	Downloads (Click cells for linked documents)	
<b>100W</b>		

### Dali 2 Drivers + Lutron Athena Node

	Specifications	
	ENEC & UL approved	Range 100-277VAC
	Output constant voltage (NFC regulation)	Standby power consumption ≤0.5W
	Downloads (Click cells for linked documents)	
<b>96W</b>	<b>Lutron Athena Node</b>	

### Dali 2 Drivers

	Specifications	
	ENEC & UL approved	Range 100-277VAC
	Output constant voltage (NFC regulation)	Standby power consumption ≤0.5W
	Downloads (Click cells for linked documents)	
<b>96W</b>		

### Lutron Drivers

	Specifications	
	UL Listed	24V Constant Voltage Output, Class2
	Universal Input Voltage: 120-277VAC	Continuous dimming down to 0.1%
	Downloads (Click cells for linked documents)	
<b>Hi-Lume Premier</b>		

## Compatible Products

Click on product names for more information.

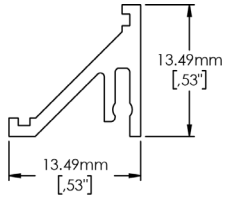

**CONNOR**

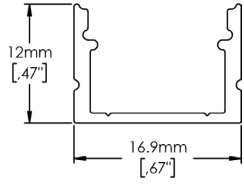

**DOBY**

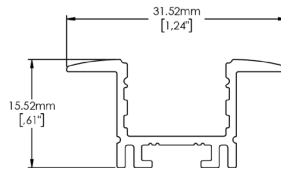

**JAXSON**

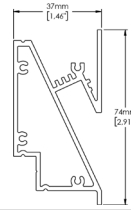

**MYLA**

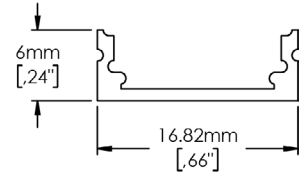

**OLIVIA**

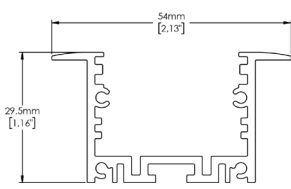

**PALAZO MASTER**

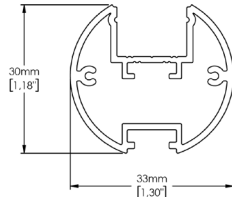

**POLA**

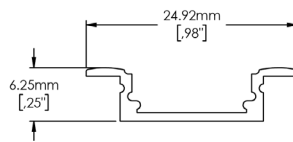

**ROBERTHA**

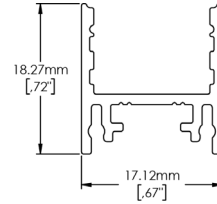

**ROCCO**

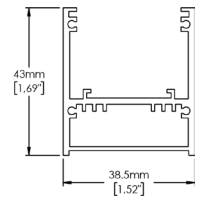

**VENGA**

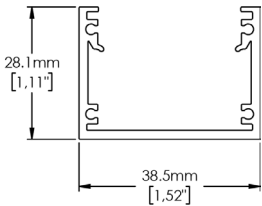

**VENGA SLIM**

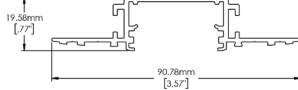

**VENGA SLIM TRIMLESS**

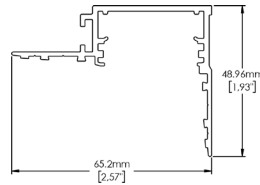

**VENGA SLIM TRIMLESS PERIMETER**

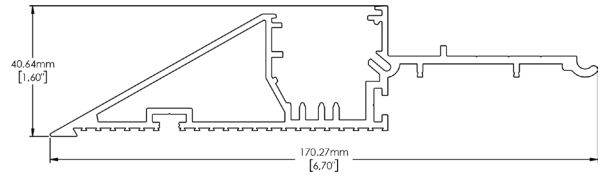

**ARKALUX**