

120lm/ft Static White LED Strip

Lumen Warm's IC series is a high-performance specification grade range of LED strips. The built in IC technology guarantees a stable luminous flux along your run by managing voltage along the strip. This series offers a 95+ CRI, single bin two step colour consistency and a range of 120 to 700 lumens per foot, with as high as 120 lumens per watt.

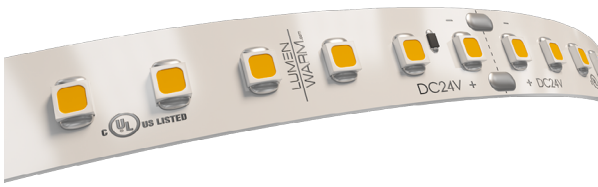

Highlights

Colour Temperature	2700K, 3000K, 3500K, 4000K
CRI*	95+ 2 Step MacAdam Ellipse
Lumen Output	115lm/ft 380lm/m
Lumen/Watt	127lm/W
Driver	Remote Driver; 100~277V

*Please note this information is based off a 4000K LED Source.

Input Voltage	24VDC
Consumption	0.91W/ft 3W/m
Dimming Options	ELDR, DIM, DMX, DALI 2, DALI 2 + ATHENA NODE & LUTRON
Mounting	3M VHB premium quality double side tape
Applications	Dry or damp environment, low output light fixtures, millworks, cove, shelves, displays and much more.

*Please note this information is based off a 4000K LED Source.

Technical Information

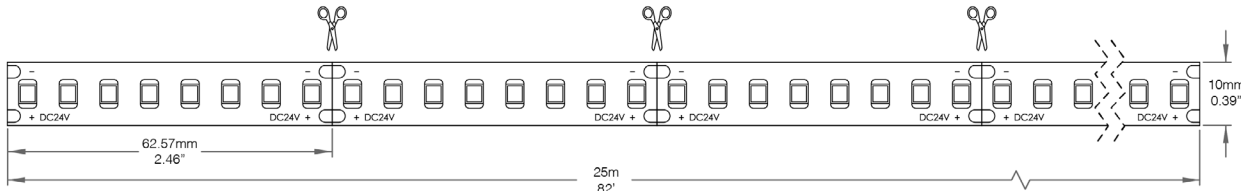

Ordering Options

Ex: LWHPC120-5m-27K-NA-NA

Product Code	Length	Colour Temperature	Lead In	Lead Out
LWHPC120	5m 25m CU Custom (0)	27K 2700K 30K 3000K 35K 3500K 40K 4000K CU Custom	DC7IN FT6 DC Quick Connect 7in DC3FT FT6 DC Quick Connect 3ft FT43FT FT4 Cable 3ft TC3FT Twin Cable 3ft CUCBL Custom Cable NA None (1)	DC7IN FT6 DC Quick Connect 7in DC3FT FT6 DC Quick Connect 3ft FT43FT FT4 Cable 3ft TC3FT Twin Cable 3ft CUCBL Custom Cable NA None (2)
	(0) Specify length & unit of measurement		(1) Refer to the following pages to select LED Strip Connectors, Junction Boxes & Wire Connectors.	(2) Refer to the following pages to select LED Strip Connectors, Junction Boxes & Wire Connectors.

Colour Temperature

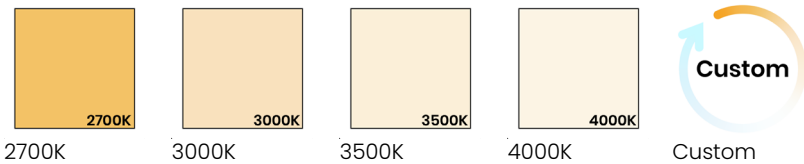

Light Loss Factor per Colour Temperature	Maximum Run per Driver
4000K	0% 30W 27.35ft 8.34m
3500K	8% 60W 54.69ft 16.67m
3000K	17% 75W 68.36ft 20.84m
2700K	21% 96W 87.50ft 26.67m
2400K	24% * Tape must be refeed every 30ft max to avoid voltage drop. *
1800K	26%

Technical Information

Parts Layout - LED Strip Connectors

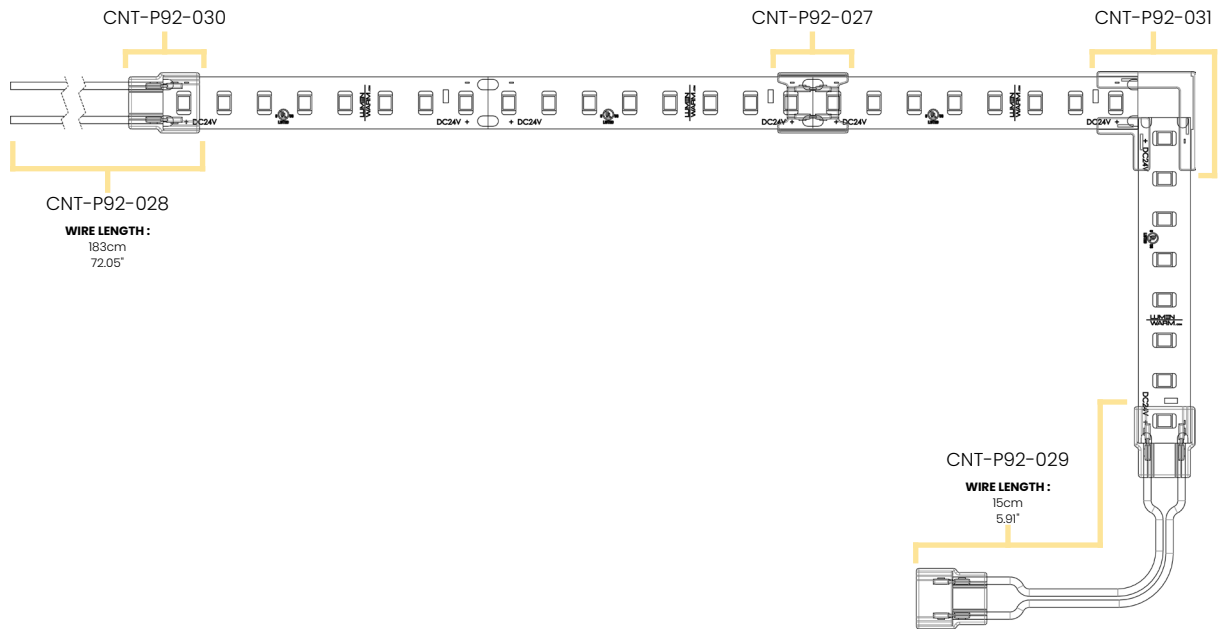

Dimensions

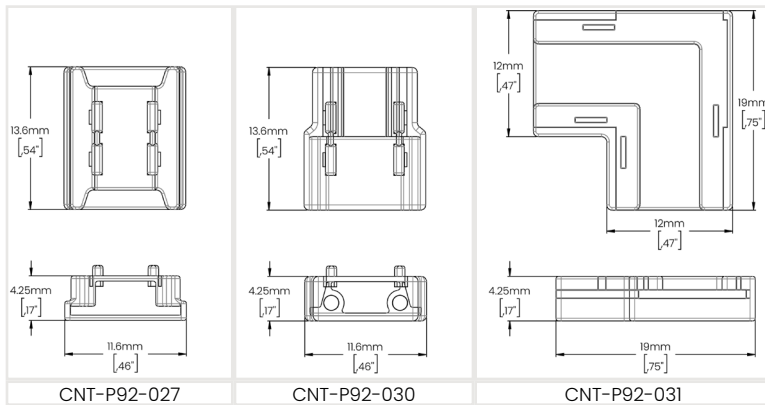

Ordering Options

LED Strip Connectors			
Code	CNT-P92-027	Quantity	
Code	CNT-P92-028	Quantity	
Code	CNT-P92-029	Quantity	
Code	CNT-P92-030	Quantity	
Code	CNT-P92-031	Quantity	

Workshop Drawing

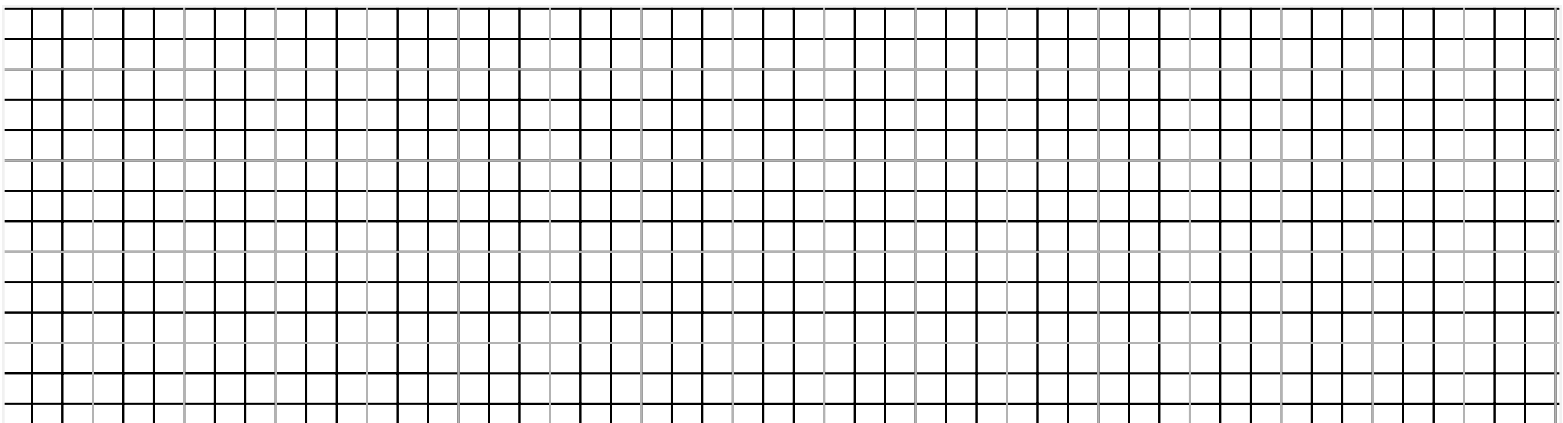

Technical Information

Parts Layout - Splice Boxes & Wire Connectors

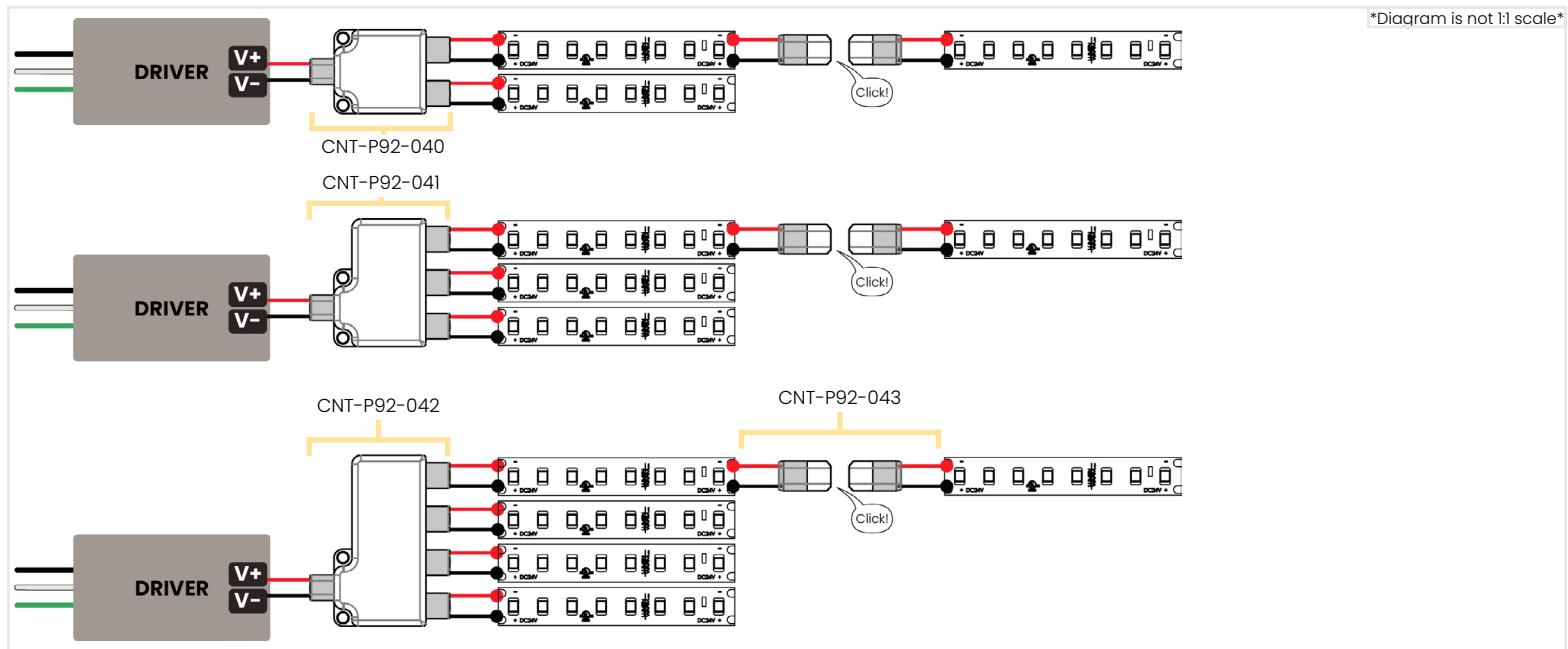

Dimensions

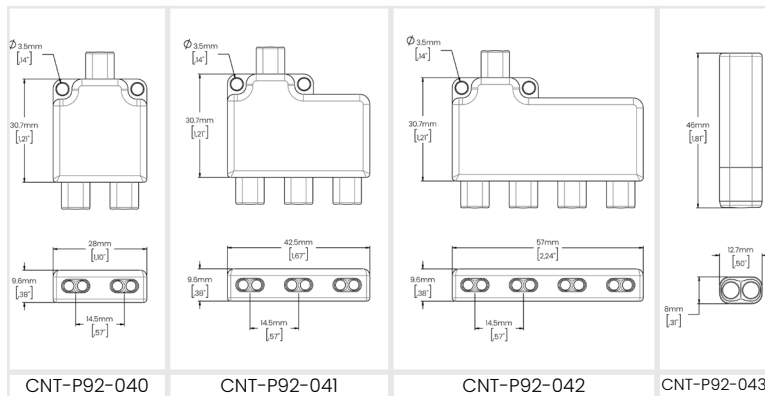

Specifications

Part	Specifications
CNT-P92-040	Rated Voltage: 12-48V
CNT-P92-041	Rated Current: 4A
CNT-P92-042	Working Environment Temperature: 14°F ~ 113°F / -10°C ~ 45°C
	Temperature Resistance: 221°F / 105°C
	Flame Retardant Grade: Complies with UL-94-V0

Ordering Options

Splice Boxes		
Code	CNT-P92-040	Quantity
Code	CNT-P92-041	Quantity
Code	CNT-P92-042	Quantity
Wire Connectors		
Code	CNT-P92-043	Quantity

Part	Specifications
CNT-P92-043	Rated Voltage: 300V
	Rated Current: 9A
	Working Environment Temperature: 14°F ~ 113°F / -10°C ~ 45°C
	Temperature Resistance: 221°F / 105°C
	Flame Retardant Grade: Complies with UL-94-V0
	Conductor Cross Section: 18 ~ 16AWG / 0.0012 ~ 0.0020in ²
	Max. Insulation Outer Diameter: Ø0.12in

Compatible Drivers

Non-Dimmable Drivers



Specifications	
UL Listed	IP66 rating, suitable for outdoor use
Universal Input Voltage, full range	24V Constant Voltage Output, Class2
Downloads (Click cells for linked documents)	
30W	96W
60W	288W

Five-in-One Dimmable Drivers



Specifications	
UL Listed	IP67 rating, suitable for indoor use
Universal Input Voltage: 100-277VAC	24V Constant Voltage Output, Class2
Downloads (Click cells for linked documents)	
30W	192W
60W	288W
96W	

DMX Drivers



Specifications	
Universal Input Voltage: 100-277VAC	24V Constant Voltage Output, Class2
IP20 rating, suitable for indoor use	Compatible with Lumen Warm Controllers
Downloads (Click cells for linked documents)	
100W	

Dali 2 Drivers + Lutron Athena Node



Specifications	
ENEC & UL approved	Range 100-277VAC
Output constant voltage (NFC regulation)	Standby power consumption ≤0.5W
Downloads (Click cells for linked documents)	
96W	Lutron Athena Node

Dali 2 Drivers



Specifications	
ENEC & UL approved	Range 100-277VAC
Output constant voltage (NFC regulation)	Standby power consumption ≤0.5W
Downloads (Click cells for linked documents)	
96W	

Lutron Drivers



Specifications	
UL Listed	24V Constant Voltage Output, Class2
Universal Input Voltage: 120-277VAC	Continuous dimming down to 0.1%
Downloads (Click cells for linked documents)	
Hi-Lume Premier	

Compatible Products

Click on product names for more information.

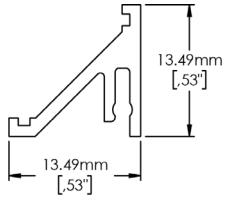

CONNOR

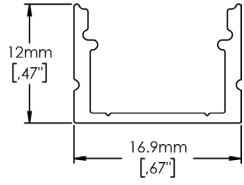

DOBY

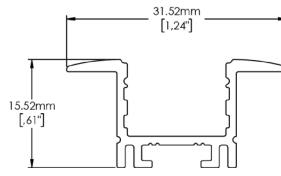

JAXSON

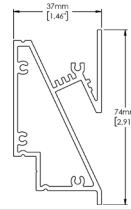

MYLA

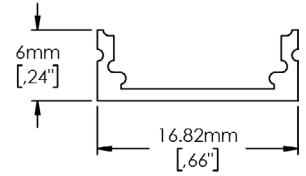

OLIVIA

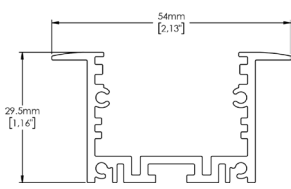

PALAZO MASTER

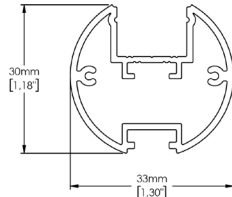

POLA

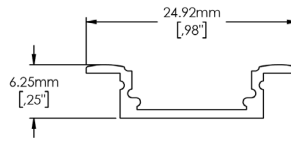

ROBERTHA

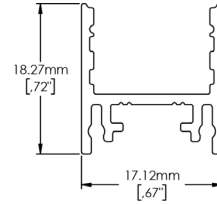

ROCCO

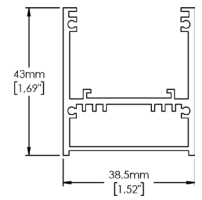

VENGA

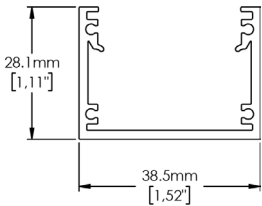

VENGA SLIM

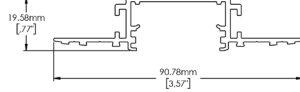

VENGA SLIM TRIMLESS

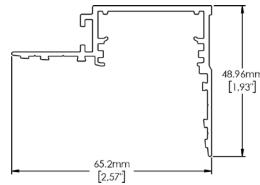

VENGA SLIM TRIMLESS PERIMETER

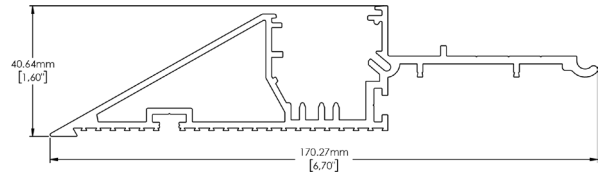

ARKALUX