

# 290lm/ft Static White LED Strip

Lumen Warm's IC series is a high-performance specification grade range of LED strips. The built in IC technology guarantees a stable luminous flux along your run by managing voltage along the strip. This series offers a 95+ CRI, single bin two step colour consistency and a range of 120 to 700 lumens per foot, with as high as 120 lumens per watt.

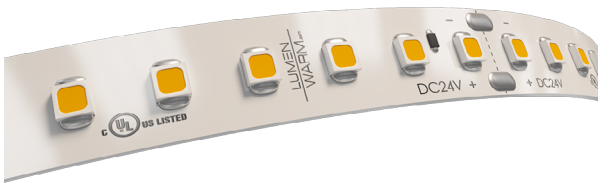

## Highlights

<b>Colour Temperature</b>	2700K, 3000K, 3500K, 4000K
<b>CRI*</b>	95+   2 Step MacAdam Ellipse
<b>Lumen Output</b>	285lm/ft   935lm/m
<b>Lumen/Watt</b>	110lm/W
<b>Driver</b>	Remote Driver; 100~277V

\*Please note this information is based off a 4000K LED Source.

<b>Input Voltage</b>	24VDC
<b>Consumption</b>	2.59W/ft   8.5W/m
<b>Dimming Options</b>	ELDR, DIM, DMX, DALI 2, DALI 2 + ATHENA NODE & LUTRON
<b>Mounting</b>	3M VHB premium quality double side tape
<b>Applications</b>	Dry or damp environment, low output light fixtures, millworks, cove, shelves, displays and much more.

\*Please note this information is based off a 4000K LED Source.

## Technical Information

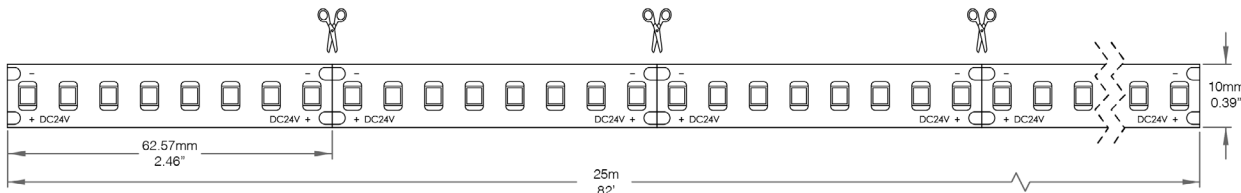

## Ordering Options

Ex : LWHPC290-5m-27K-NA-NA

Product Code	Length	Colour Temperature	Lead In	Lead Out
<b>LWHPC290</b>				
	5m 25m CU Custom (0)	27K 2700K 30K 3000K 35K 3500K 40K 4000K CU Custom	DC7IN FT6 DC Quick Connect 7in DC3FT FT6 DC Quick Connect 3ft FT43FT FT4 Cable 3ft TC3FT Twin Cable 3ft CUCBL Custom Cable NA None (1)	DC7IN FT6 DC Quick Connect 7in DC3FT FT6 DC Quick Connect 3ft FT43FT FT4 Cable 3ft TC3FT Twin Cable 3ft CUCBL Custom Cable NA None (2)
	(0) Specify length & unit of measurement		(1) Refer to the following pages to select LED Strip Connectors, Junction Boxes & Wire Connectors.	(2) Refer to the following pages to select LED Strip Connectors, Junction Boxes & Wire Connectors.

## Colour Temperature

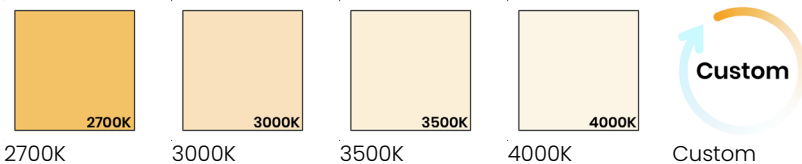

Light Loss Factor per Colour Temperature		Maximum Run per Driver	
4000K	0%	30W	9.66ft   2.95m
3500K	8%	60W	19.31ft   5.89m
3000K	17%	75W	24.13ft   7.36m
2700K	21%	96W	30.89ft   9.42m
2400K	24%	* Tape must be refeed every 30ft max to avoid voltage drop. *	
1800K	26%		

# Technical Information

## Parts Layout - LED Strip Connectors

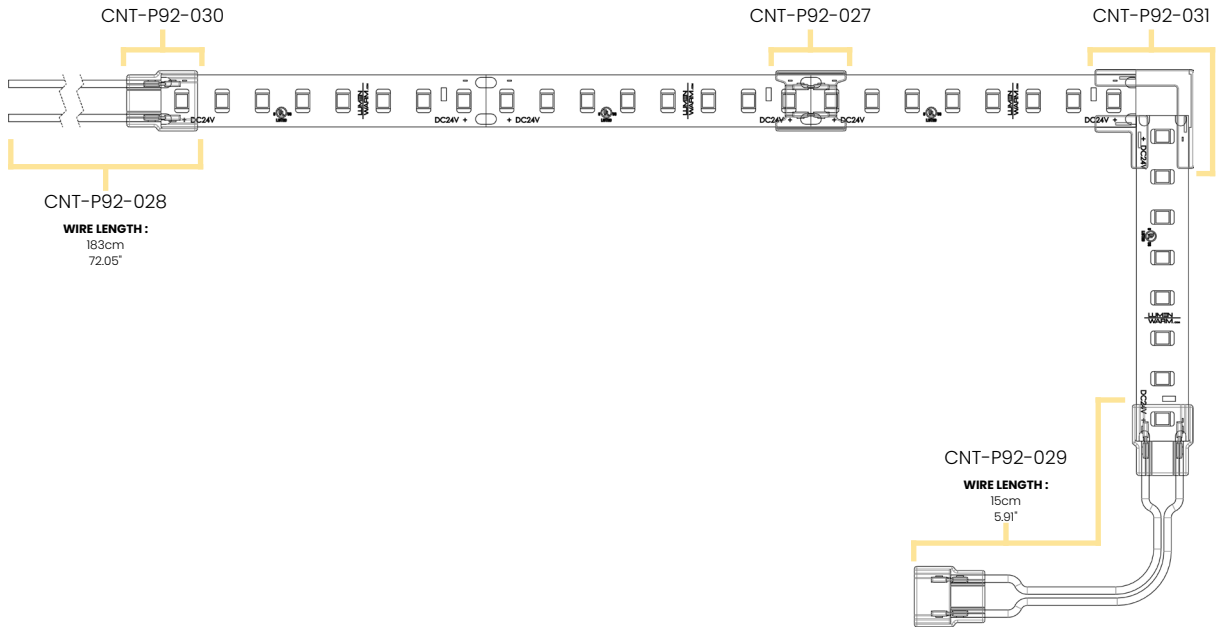

### Dimensions

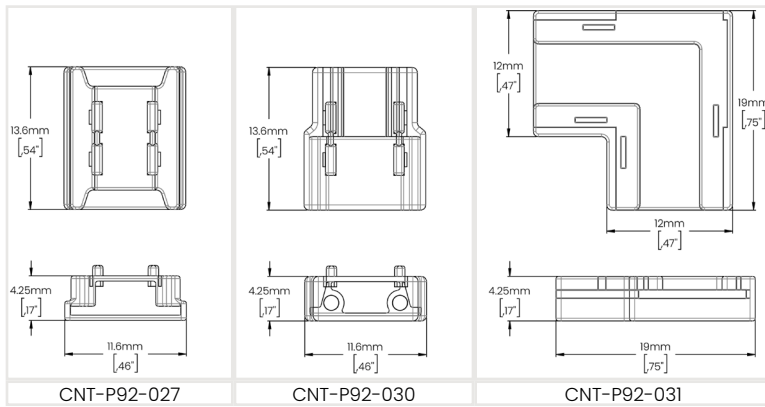

### Ordering Options

LED Strip Connectors			
Code	CNT-P92-027	Quantity	
Code	CNT-P92-028	Quantity	
Code	CNT-P92-029	Quantity	
Code	CNT-P92-030	Quantity	
Code	CNT-P92-031	Quantity	

### Workshop Drawing

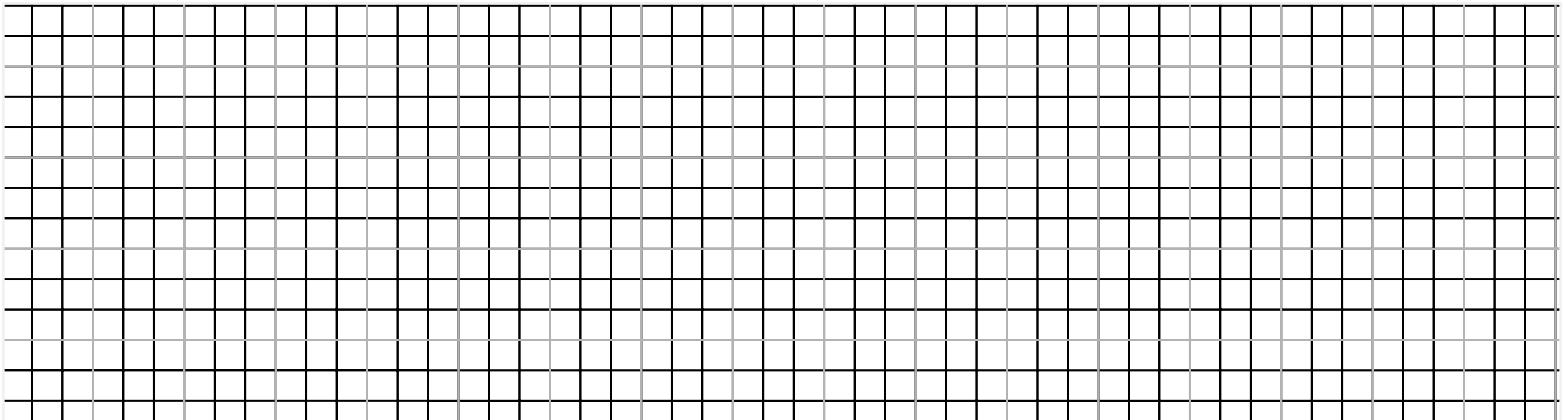

# Technical Information

## Parts Layout - Splice Boxes & Wire Connectors

\*Diagram is not 1:1 scale\*

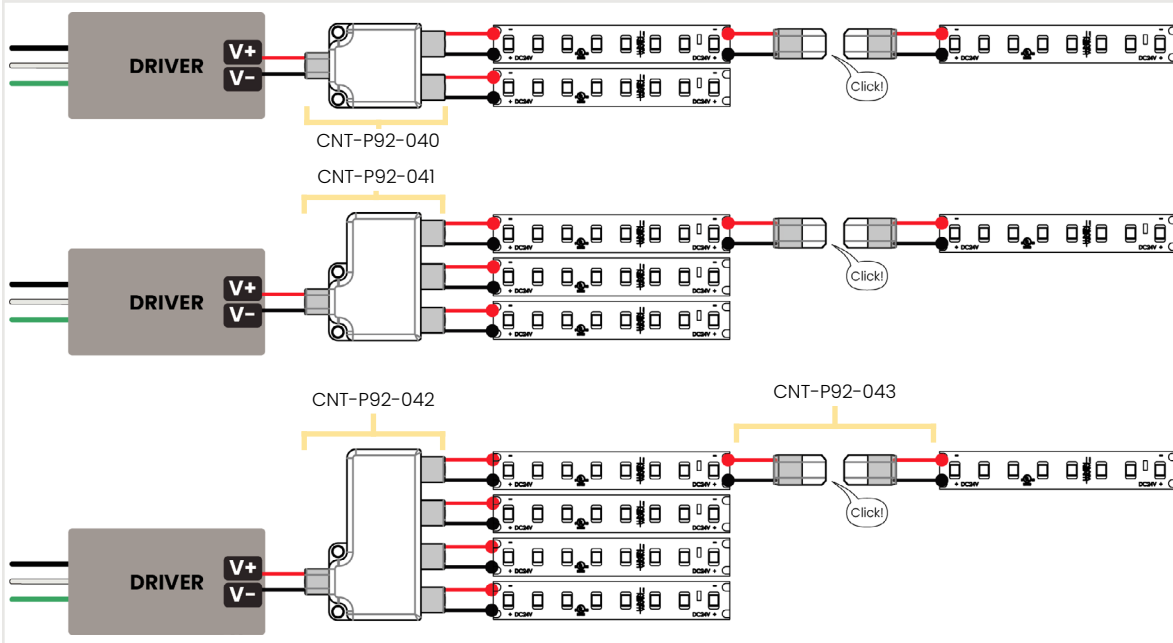

## Dimensions

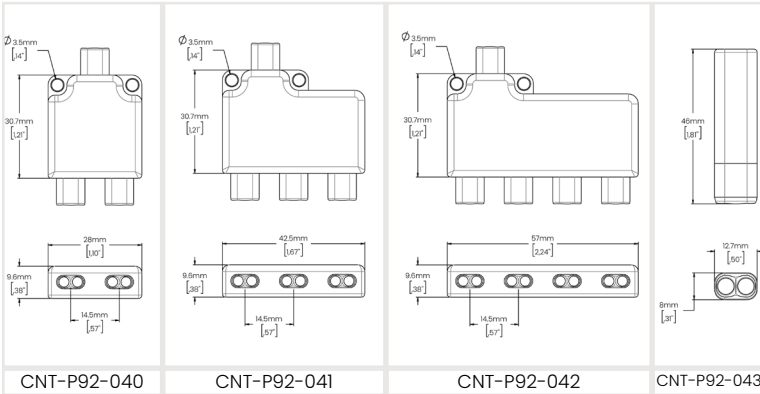

## Specifications

	CNT-P92-040	CNT-P92-041	CNT-P92-042
<b>Rated Voltage</b>	12-48V		
<b>Rated Current</b>	4A		
<b>Working Environment Temperature</b>	14°F ~ 113°F / -10°C ~ 45°C		
<b>Temperature Resistance</b>	221°F / 105°C		
<b>Flame Retardant Grade</b>	Complies with UL-94-V0		

## Ordering Options

### Splice Boxes

Code	Quantity
CNT-P92-040	
CNT-P92-041	
CNT-P92-042	

### Wire Connectors

Code	Quantity
CNT-P92-043	

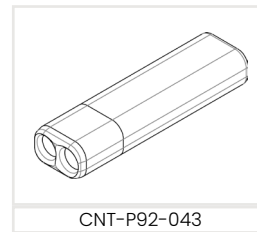

<b>Rated Voltage</b>	300V
<b>Rated Current</b>	9A
<b>Working Environment Temperature</b>	14°F ~ 113°F / -10°C ~ 45°C
<b>Temperature Resistance</b>	221°F / 105°C
<b>Flame Retardant Grade</b>	Complies with UL-94-V0
<b>Conductor Cross Section</b>	18 ~ 16AWG / 0.0012 ~ 0.0020in <sup>2</sup>
<b>Max. Insulation Outer Diameter</b>	Ø0.12in

## Compatible Drivers

### Non-Dimmable Drivers

	Specifications	
	UL Listed	IP66 rating, suitable for outdoor use
	Universal Input Voltage, full range	24V Constant Voltage Output, Class2
	Downloads (Click cells for linked documents)	
<b>30W</b>	<b>96W</b>	
<b>60W</b>	<b>288W</b>	

### Five-in-One Dimmable Drivers

	Specifications	
	UL Listed	IP67 rating, suitable for indoor use
	Universal Input Voltage: 100-277VAC	24V Constant Voltage Output, Class2
	Downloads (Click cells for linked documents)	
<b>30W</b>	<b>192W</b>	
<b>60W</b>	<b>288W</b>	
<b>96W</b>		

### DMX Drivers

	Specifications	
	Universal Input Voltage: 100-277VAC	24V Constant Voltage Output, Class2
	IP20 rating, suitable for indoor use	Compatible with Lumen Warm Controllers
	Downloads (Click cells for linked documents)	
<b>100W</b>		

### Dali 2 Drivers + Lutron Athena Node

	Specifications	
	ENEC & UL approved	Range 100-277VAC
	Output constant voltage (NFC regulation)	Standby power consumption ≤0.5W
	Downloads (Click cells for linked documents)	
<b>96W</b>	<b>Lutron Athena Node</b>	

### Dali 2 Drivers

	Specifications	
	ENEC & UL approved	Range 100-277VAC
	Output constant voltage (NFC regulation)	Standby power consumption ≤0.5W
	Downloads (Click cells for linked documents)	
<b>96W</b>		

### Lutron Drivers

	Specifications	
	UL Listed	24V Constant Voltage Output, Class2
	Universal Input Voltage: 120-277VAC	Continuous dimming down to 0.1%
	Downloads (Click cells for linked documents)	
<b>Hi-Lume Premier</b>		

## Compatible Products

Click on product names for more information.

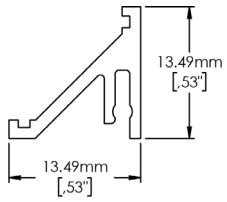

**CONNOR**

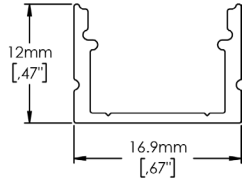

**DOBY**

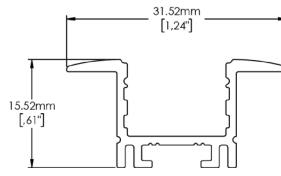

**JAXSON**

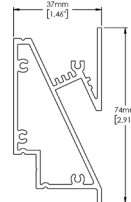

**MYLA**

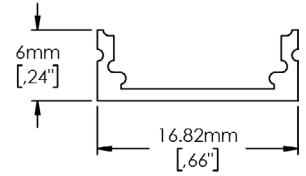

**OLIVIA**

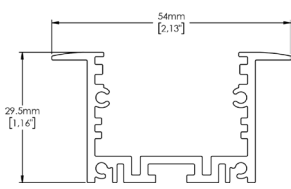

**PALAZO MASTER**

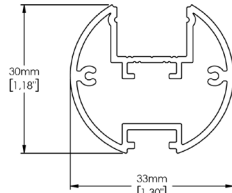

**POLA**

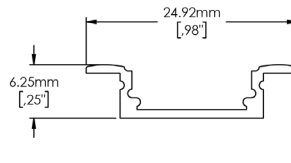

**ROBERTHA**

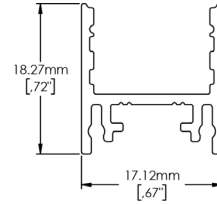

**ROCCO**

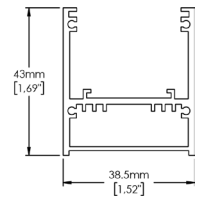

**VENGA**

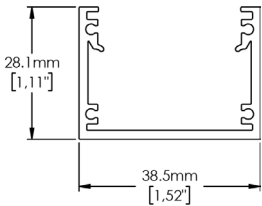

**VENGA SLIM**

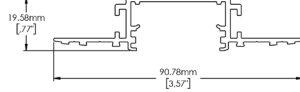

**VENGA SLIM TRIMLESS**

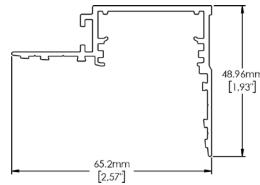

**VENGA SLIM TRIMLESS PERIMETER**

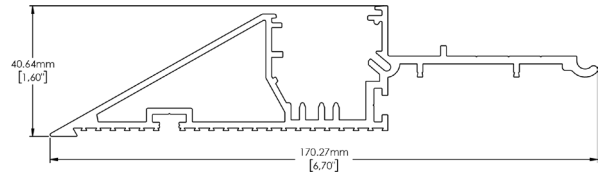

**ARKALUX**