

700lm/ft Static White LED Strip

Lumen Warm's IC series is a high-performance specification grade range of LED strips. The built in IC technology guarantees a stable luminous flux along your run by managing voltage along the strip. This series offers a 95+ CRI, single bin two step colour consistency and a range of 120 to 700 lumens per foot, with as high as 120 lumens per watt.



Highlights

Colour Temperature	2700K, 3000K, 3500K, 4000K
CRI*	95+ 2 Step MacAdam Ellipse
Lumen Output	702lm/ft 2304lm/m
Lumen/Watt	120lm/W
Driver	Remote Driver; 100~277V

*Please note this information is based off a 4000K LED Source.

Input Voltage	24VDC
Consumption	5.85W/ft 19.2W/m
Dimming Options	ELDR, DIM, DMX, DALI 2, DALI 2 + ATHENA NODE & LUTRON
Mounting	3M VHB premium quality double side tape
Applications	Dry or damp environment, low output light fixtures, millworks, cove, shelves, displays and much more.

*Please note this information is based off a 4000K LED Source.

Technical Information

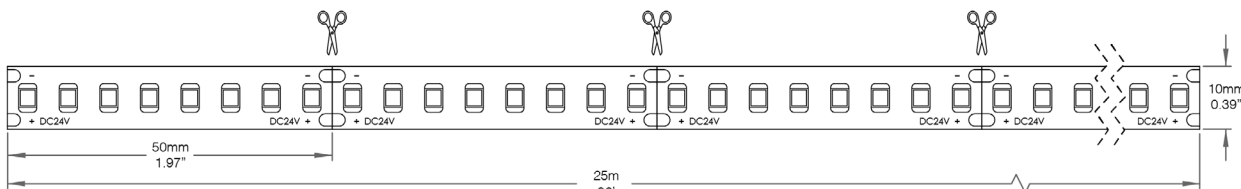

Ordering Options

Ex : LWHPC700-5m-27K-NA-NA

Product Code	Length	Colour Temperature	Lead In	Lead Out
LWHPC700				
	5m 5m 25m 25m CU Custom (0)	27K 2700K 30K 3000K 35K 3500K 40K 4000K CU Custom	DC7IN FT6 DC Quick Connect 7in DC3FT FT6 DC Quick Connect 3ft FT43FT FT4 Cable 3ft TC3FT Twin Cable 3ft CUCBL Custom Cable NA None (1)	DC7IN FT6 DC Quick Connect 7in DC3FT FT6 DC Quick Connect 3ft FT43FT FT4 Cable 3ft TC3FT Twin Cable 3ft CUCBL Custom Cable NA None (2)
	(0) Specify length & unit of measurement		(1) Refer to the following pages to select LED Strip Connectors, Junction Boxes & Wire Connectors.	(2) Refer to the following pages to select LED Strip Connectors, Junction Boxes & Wire Connectors.

Colour Temperature

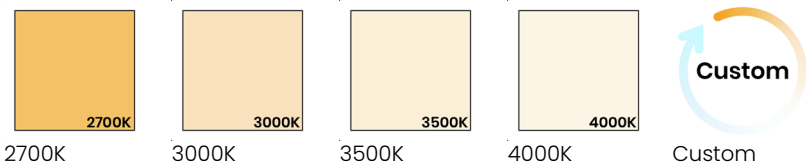

Light Loss Factor per Colour Temperature		Maximum Run per Driver	
4000K	0%	30W	4.28ft 1.31m
3500K	8%	60W	8.55ft 2.61m
3000K	17%	75W	10.69ft 3.26m
2700K	21%	96W	13.68ft 4.17m
2400K	24%	* Tape must be refeed every 30ft max to avoid voltage drop. *	
1800K	26%		

Technical Information

Parts Layout - LED Strip Connectors

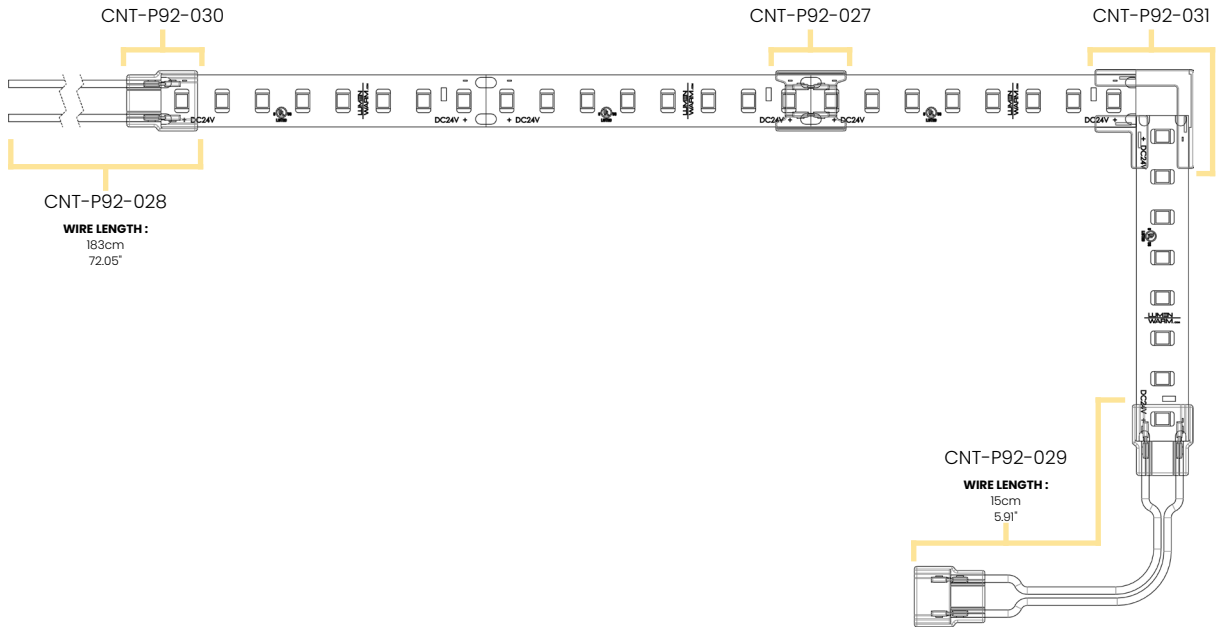

Dimensions

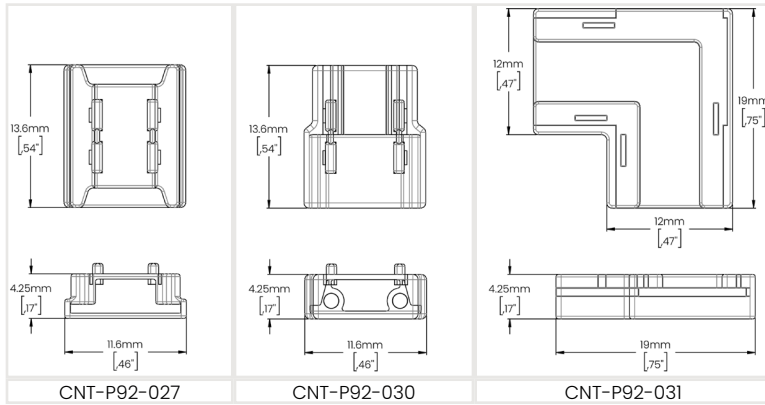

Ordering Options

LED Strip Connectors			
Code	CNT-P92-027	Quantity	
Code	CNT-P92-028	Quantity	
Code	CNT-P92-029	Quantity	
Code	CNT-P92-030	Quantity	
Code	CNT-P92-031	Quantity	

Workshop Drawing

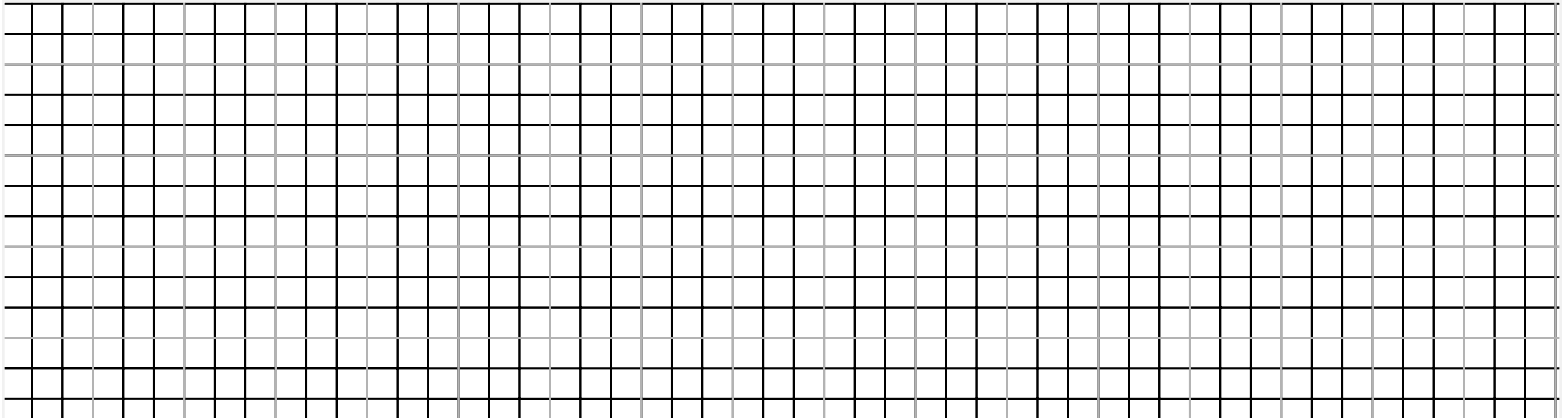

Technical Information

Parts Layout - Splice Boxes & Wire Connectors

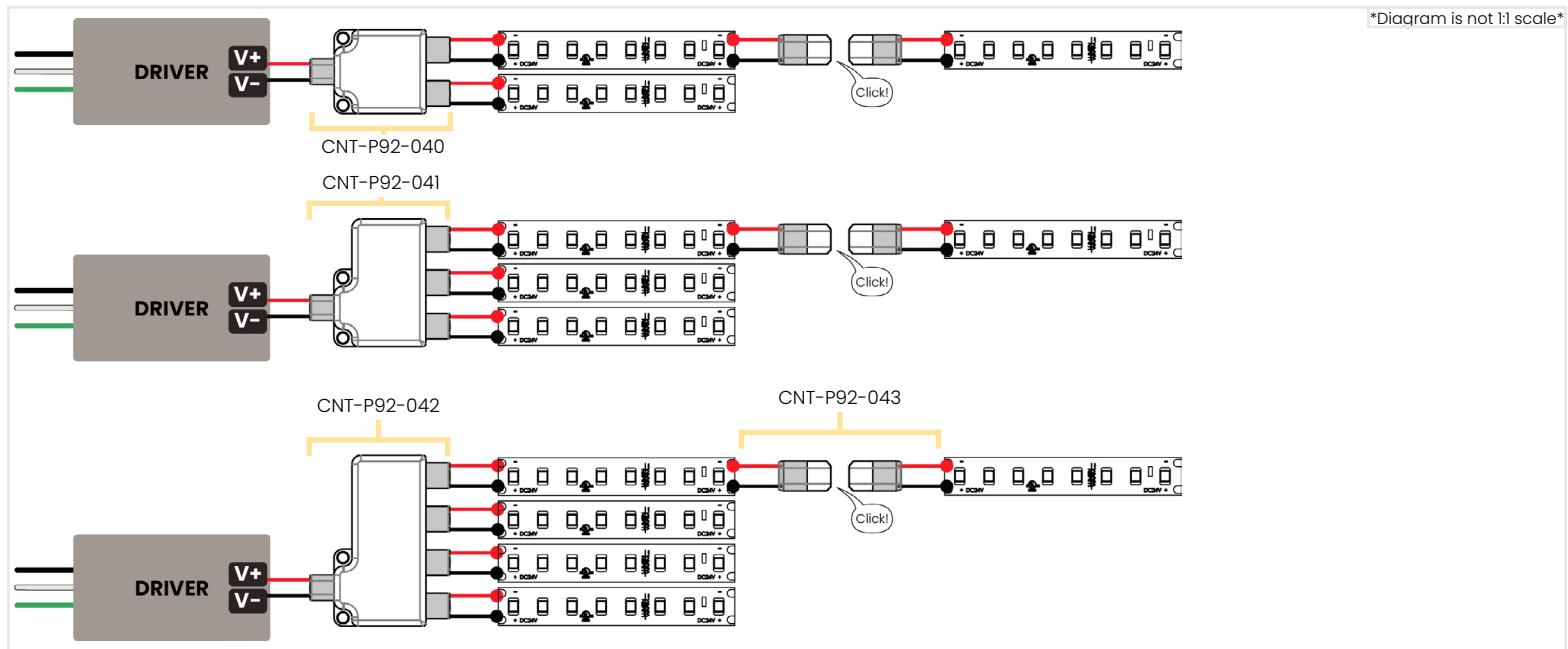

Dimensions

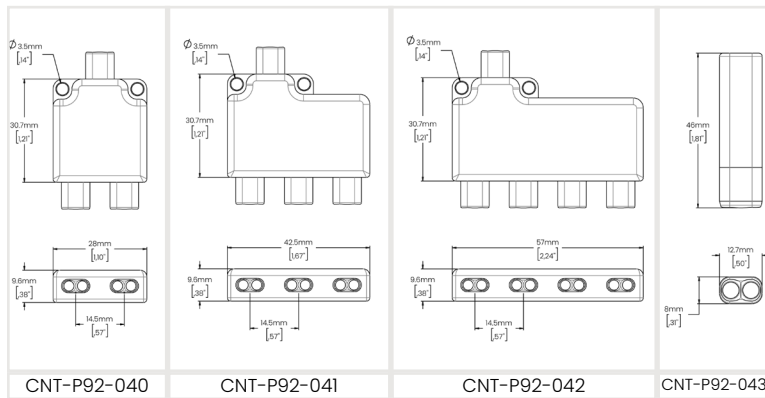

Specifications

Part	Rated Voltage	Rated Current	Working Environment Temperature	Temperature Resistance	Flame Retardant Grade
CNT-P92-040	12-48V	4A	14°F ~ 113°F / -10°C ~ 45°C	221°F / 105°C	Complies with UL-94-V0
CNT-P92-041					
CNT-P92-042					

Ordering Options

Splice Boxes

Code	Quantity
CNT-P92-040	
CNT-P92-041	
CNT-P92-042	

Wire Connectors

Code	Quantity
CNT-P92-043	

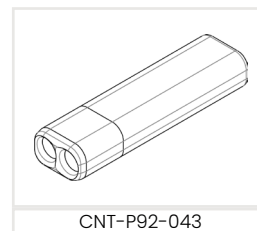

Part	Rated Voltage	Rated Current	Working Environment Temperature	Temperature Resistance	Flame Retardant Grade	Conductor Cross Section	Max. Insulation Outer Diameter
CNT-P92-043	300V	9A	14°F ~ 113°F / -10°C ~ 45°C	221°F / 105°C	Complies with UL-94-V0	18 ~ 16AWG / 0.0012 ~ 0.0020in ²	Ø0.12in

Compatible Drivers

Non-Dimmable Drivers

	Specifications	
	UL Listed	IP66 rating, suitable for outdoor use
	Universal Input Voltage, full range	24V Constant Voltage Output, Class2
	Downloads (Click cells for linked documents)	
30W	96W	
60W	288W	

Five-in-One Dimmable Drivers

	Specifications	
	UL Listed	IP67 rating, suitable for indoor use
	Universal Input Voltage: 100-277VAC	24V Constant Voltage Output, Class2
	Downloads (Click cells for linked documents)	
30W	192W	
60W	288W	
96W		

DMX Drivers

	Specifications	
	Universal Input Voltage: 100-277VAC	24V Constant Voltage Output, Class2
	IP20 rating, suitable for indoor use	Compatible with Lumen Warm Controllers
	Downloads (Click cells for linked documents)	
100W		

Dali 2 Drivers + Lutron Athena Node

	Specifications	
	ENEC & UL approved	Range 100-277VAC
	Output constant voltage (NFC regulation)	Standby power consumption ≤0.5W
	Downloads (Click cells for linked documents)	
96W	Lutron Athena Node	

Dali 2 Drivers

	Specifications	
	ENEC & UL approved	Range 100-277VAC
	Output constant voltage (NFC regulation)	Standby power consumption ≤0.5W
	Downloads (Click cells for linked documents)	
96W		

Lutron Drivers

	Specifications	
	UL Listed	24V Constant Voltage Output, Class2
	Universal Input Voltage: 120-277VAC	Continuous dimming down to 0.1%
	Downloads (Click cells for linked documents)	
Hi-Lume Premier		

Compatible Products

Click on product names for more information.

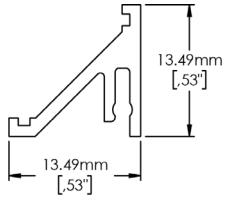

CONNOR

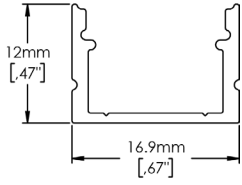

DOBY

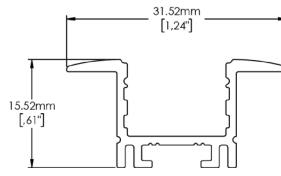

JAXSON

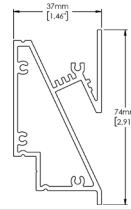

MYLA

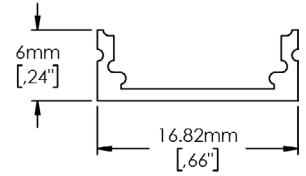

OLIVIA

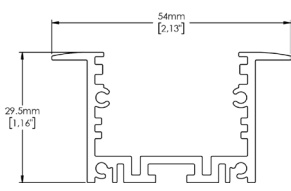

PALAZO MASTER

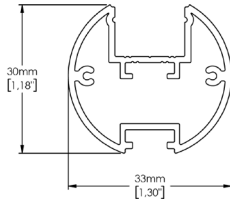

POLA

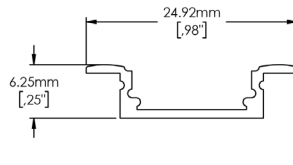

ROBERTHA

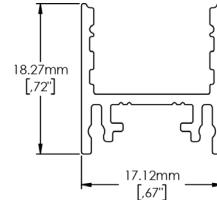

ROCCO

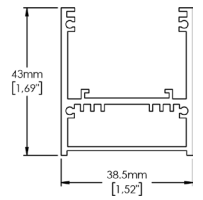

VENGA

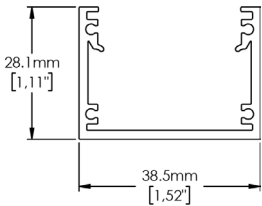

VENGA SLIM

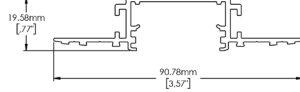

VENGA SLIM TRIMLESS

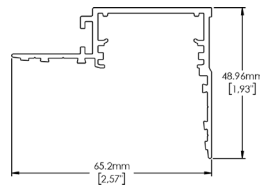

VENGA SLIM TRIMLESS PERIMETER

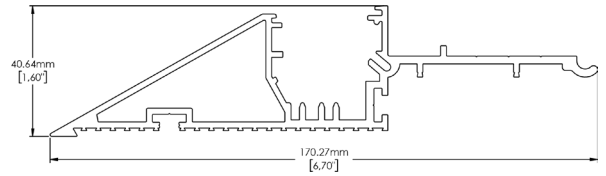

ARKALUX