

Pola Profile

Available in a variety of light intensities and application methods, our Low Voltage Linear Solutions are widely versatile. They can be used either for their functionality, as design elements in a room or both.



Highlights

Mounting	Surface Mounted in groove with Brackets or Closet Rod Installation
Material	Aluminum Extrusion (6063-T5)
Features	Versatile, optimal diffusion & easy to install
Recommended for	Design element & as closet rod

Dimensions

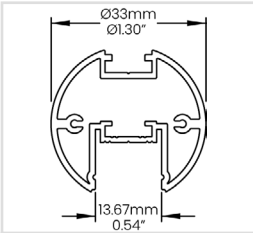

Pola Profile

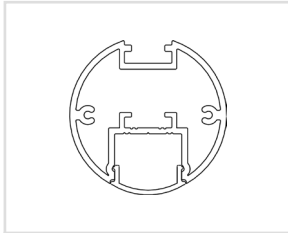

Lens : CF/WF/WO/SBC

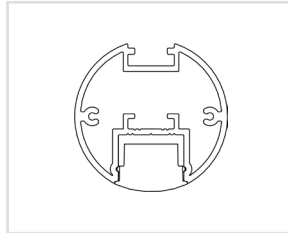

Louver : MBRCL/MWRCL

Aluminum Profile Colour



ACL - Clear Anodized

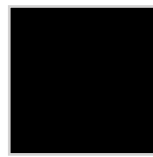

MBK - Matte Black



MWH - Matte White



CU - Custom; Specify RALK7 colour

Ordering Guide

Ex : LWPL-FIE-48IN-MBK-CF-SMDBK

Product Code	Length	Aluminum Profile Colour	Lens Options	Installation												
LWPL-FIE																
	48IN 48in 96IN 96in	ACL Clear Anodized MBK Matte Black MWH Matte White CU Custom (1)	CF Clear Frosted Lens WF White Frosted Lens WO White Opal Lens SBC Smoked Black Lens (2) MBRCL Matte Black Rectangular Louver MWRCL Matte White Rectangular Louver NA None	SMDBK Surface Mounted With Bracket (3) CRD Closet Rod Installation (4)(5) NA None												
Each profile is provided with a pair of endcaps including: 1 X Endcap without Hole 1 X Endcap with Hole		(1) Specify RALK7 code	Refer to page 2 for Lens Options (2) For pixelation free visuals, Lumen Warm strongly recommends the use of 900lm/ft LEDs.	<table border="1"> <thead> <tr> <th>Length (in)</th> <th>(3) Number of Mounting Brackets</th> <th>(4) Number of Middle Brackets</th> </tr> </thead> <tbody> <tr> <td>0-48</td> <td>2</td> <td>1</td> </tr> <tr> <td>48-84</td> <td>3</td> <td>1</td> </tr> <tr> <td>84-96</td> <td>4</td> <td>2</td> </tr> </tbody> </table> <p>(5) Includes 1 X Open Bracket and 1 X Closed Bracket</p>	Length (in)	(3) Number of Mounting Brackets	(4) Number of Middle Brackets	0-48	2	1	48-84	3	1	84-96	4	2
Length (in)	(3) Number of Mounting Brackets	(4) Number of Middle Brackets														
0-48	2	1														
48-84	3	1														
84-96	4	2														

Notes

Technical Information

Lens Options



CF/WF/WO
Clear Frosted - White Frosted -
White Opal Lens



SBC
Smoke Black Lens

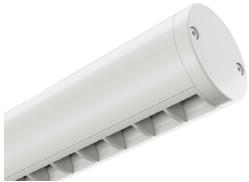

MWRCL
Matte White Rectangular Louver



MBRCL
Matte Black Rectangular Louver

LED Visibility & Light Loss Factor



CF
Clear Frosted Lens
Visible
Light Loss: 8.5%



WF
White Frosted Lens
Barely Visible
Light Loss: 23.5%



WO
White Opal Lens
Diffused
Light Loss: 37.5%



SBC
Smoke Black Lens
Barely Visible
Light Loss: 70%



MWRCL
Matte White Rectangular Louver
Visible
Light Loss: 4%



MBRCL
Matte Black Rectangular Louver
Visible
Light Loss: 8%

Installation Type

Surface Mounted with Bracket

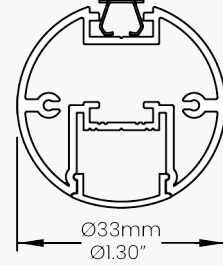

Details and Ordering

Code	BRK-P13-001
Material	Stainless Steel
Notes	LW recommends the use of #6 - 5/8" screws, not included, for their installation

Closet Rod : Open Bracket

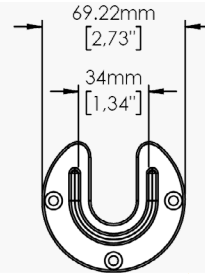

Closed Bracket

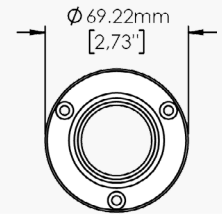

Details and Ordering

Code	Open Bracket: BRK-P13-006- _ _ _				
	Closed Bracket: BRK-P13-007- _ _ _				
To order additional brackets to those already supplied by Lumen Warm, specify the desired colour by referring to the "Colour" section below.					
Colour	<table border="0"> <tr> <td>MBK - Matte Black</td> <td>MGR - Matte Grey</td> </tr> <tr> <td>MWH - Matte White</td> <td>CU - Custom; Specify RALK7 code</td> </tr> </table>	MBK - Matte Black	MGR - Matte Grey	MWH - Matte White	CU - Custom; Specify RALK7 code
MBK - Matte Black	MGR - Matte Grey				
MWH - Matte White	CU - Custom; Specify RALK7 code				

Closet Rod - Middle Bracket

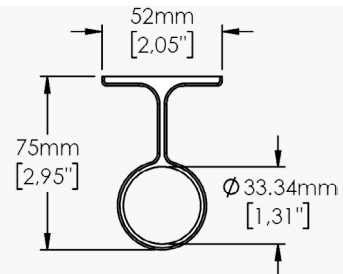

Details and Ordering

Code	BRK-P13-008- _ _ _				
To order additional brackets to those already supplied by Lumen Warm, specify the desired colour by referring to the "Colour" section below.					
Colour	<table border="0"> <tr> <td>MBK - Matte Black</td> <td>MGR - Matte Grey</td> </tr> <tr> <td>MWH - Matte White</td> <td>CU - Custom; Specify RALK7 code</td> </tr> </table>	MBK - Matte Black	MGR - Matte Grey	MWH - Matte White	CU - Custom; Specify RALK7 code
MBK - Matte Black	MGR - Matte Grey				
MWH - Matte White	CU - Custom; Specify RALK7 code				

Technical Information

Endcaps

Without Hole

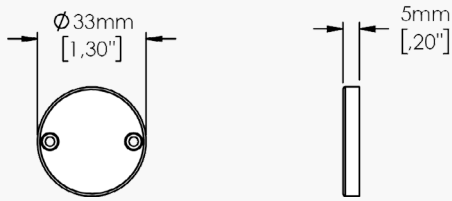

Details and Ordering

Code	ECP-P13-023- _ _ _ _	
	To order additional endcaps to those already supplied by Lumen Warm, specify the desired colour by referring to the "Colour" section below.	
Material	Aluminum	
Colour	MBK - Matte Black MWH - Matte White	MGR - Matte Grey CU - Custom; Specify RALK7 code

With Hole

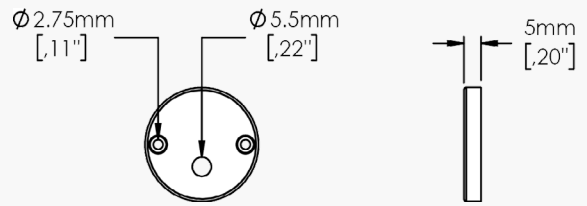

Details and Ordering

Code	ECP-P13-024- _ _ _ _	
	To order additional endcaps to those already supplied by Lumen Warm, specify the desired colour by referring to the "Colour" section below.	
Material	Aluminum	
Colour	MBK - Matte Black MWH - Matte White	MGR - Matte Grey CU - Custom; Specify RALK7 code

Available LED Strips

Static White (Click for linked document)	Lumen Output	Consumption
LWHPC120	120lm/ft - 393.6lm/m	0.91W/ft - 3W/m
LWHPC290	290lm/ft - 951.2lm/m	2.59W/ft - 8.5W/m
LWHPC420	420lm/ft - 1377.6lm/m	3.51W/ft - 11.52W/m
LWHPC700	700lm/ft - 2296lm/m	5.85W/ft - 19.2W/m
LWHP900	900lm/ft - 2952lm/m	6.59W/ft - 21.6W/m
LWHE1150	1150lm/ft - 3772lm/m	7.32W/ft - 24W/m
LWHE1400	1400lm/ft - 4592lm/m	8.78W/ft - 28.8W/m
Dim to Warm (Click for linked document)	Lumen Output	Consumption
LWD2W480	480lm/ft - 1574.4lm/m	5.27W/ft - 17.28W/m
Tunable White (Click for linked document)	Lumen Output	Consumption
LWTW220	220lm/ft - 721.6lm/m	3.05W/ft - 10W/m
LWTW300	300lm/ft - 984lm/m	4.57W/ft - 15W/m
RGBW (Click for linked document)	Lumen Output	Consumption
LWRGBW250	250lm/ft - 820lm/m	4.68W/ft - 15.36W/m