

# 250lm/ft RGBW LED Strip

Lumen Warm's Dynamic Colour series is a range of LED strips that offer Dim to Warm, Tunable White and RGBW variable colours options. They offer 90+ CRI, two Dim to Warm ranges of 1800K-3000K and 2700K-4000K and a wide range of colours to choose from using the Tunable White or the RGBW LED strip options.



## Highlights

<b>Colour Temperature</b>	3000K, 4000K + RGB
<b>CRI*</b>	95+   2 Step MacAdam Ellipse
<b>Lumen Output</b>	250lm/ft   820lm/m
<b>Lumen/Watt</b>	53lm/W
<b>Driver</b>	Remote Driver; 100~277V

\*Please note this information is based off a 4000K LED Source.

<b>Input Voltage</b>	24VDC
<b>Consumption</b>	4.68W/ft   15.36W/m
<b>Dimming Options</b>	DMX
<b>Mounting</b>	3M VHB premium quality double side tape
<b>Applications</b>	Dry or damp environment, low output light fixtures, millworks, cove, shelves, displays and much more.

\*Please note this information is based off a 4000K LED Source.

## Technical Information

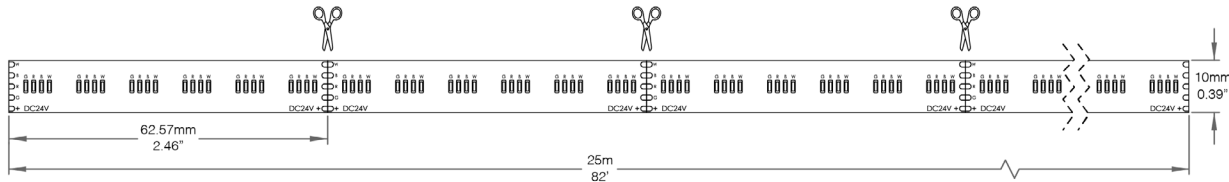

## Ordering Options

Ex : LWRGBW250-5m-30K-NA-NA

Product Code	Length	Colour Temperature	Lead In	Lead Out
<b>LWRGBW250</b>	5m 25m CU Custom (0)	30K 3000K 40K 4000K CU Custom	FT43FT FT4 Cable 3ft CUCBL Custom Cable NA None (1)	FT43FT FT4 Cable 3ft CUCBL Custom Cable NA None (2)
	(0) Specify length & unit of measurement		(1) Refer to the following pages to select LED Strip Connectors, Junction Boxes & Wire Connectors.	(2) Refer to the following pages to select LED Strip Connectors, Junction Boxes & Wire Connectors.

## Colour Temperature

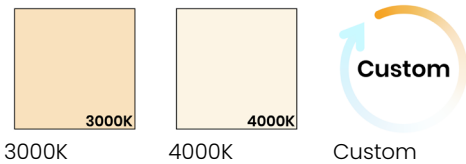

Light Loss Factor per Colour Temperature		Maximum Run per Driver	
4000K	0%	30W	5.35ft   1.63m
3500K	8%	60W	10.69ft   3.26m
3000K	17%	75W	13.36ft   4.07m
2700K	21%	96W	17.09ft   5.21m
2400K	24%	* Tape must be refeed every 30ft max to avoid voltage drop. *	
1800K	26%		

# Technical Information

## Parts Layout - LED Strip Connectors

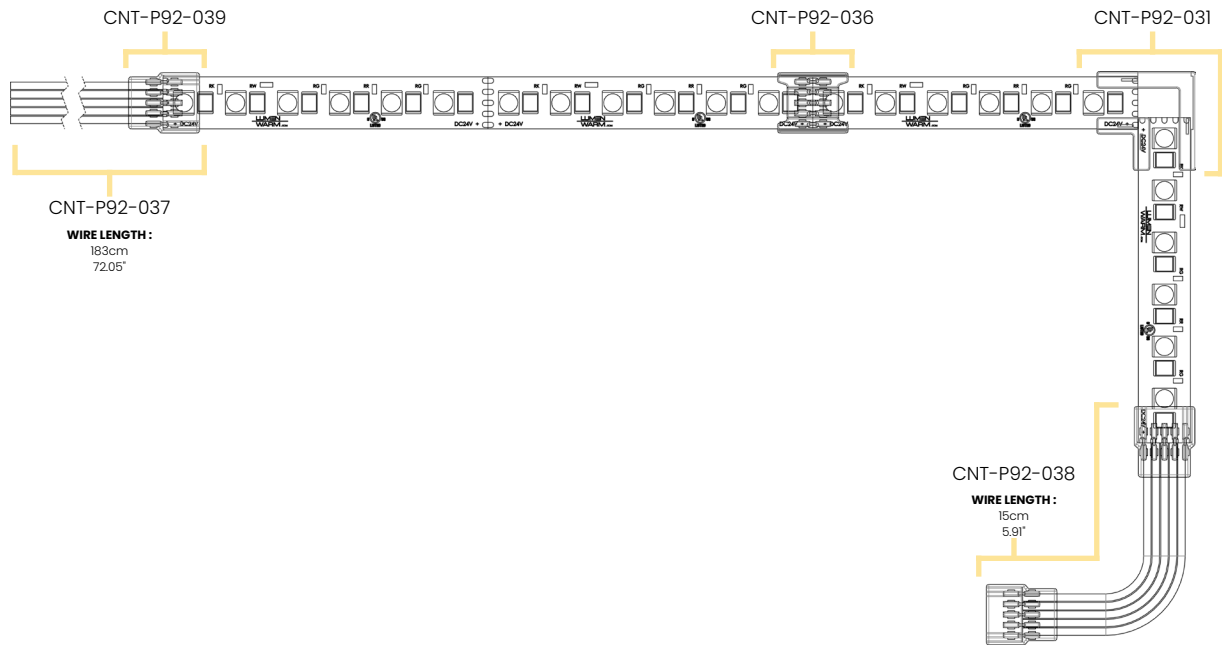

## Dimensions

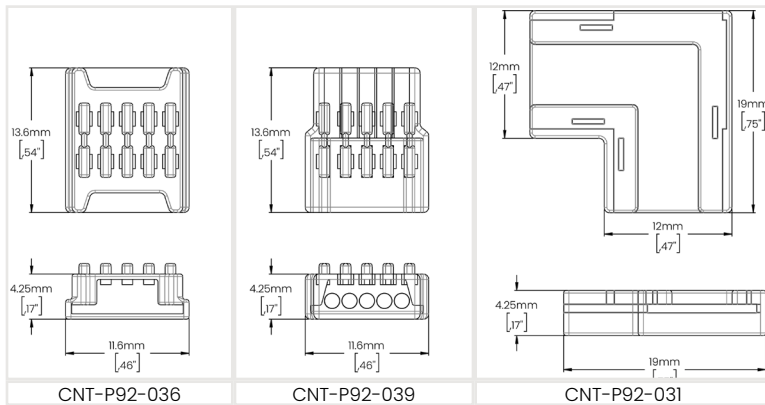

## Ordering Options

LED Strip Connectors			
<b>Code</b>	CNT-P92-031	<b>Quantity</b>	
<b>Code</b>	CNT-P92-036	<b>Quantity</b>	
<b>Code</b>	CNT-P92-037	<b>Quantity</b>	
<b>Code</b>	CNT-P92-038	<b>Quantity</b>	
<b>Code</b>	CNT-P92-039	<b>Quantity</b>	

## Workshop Drawing

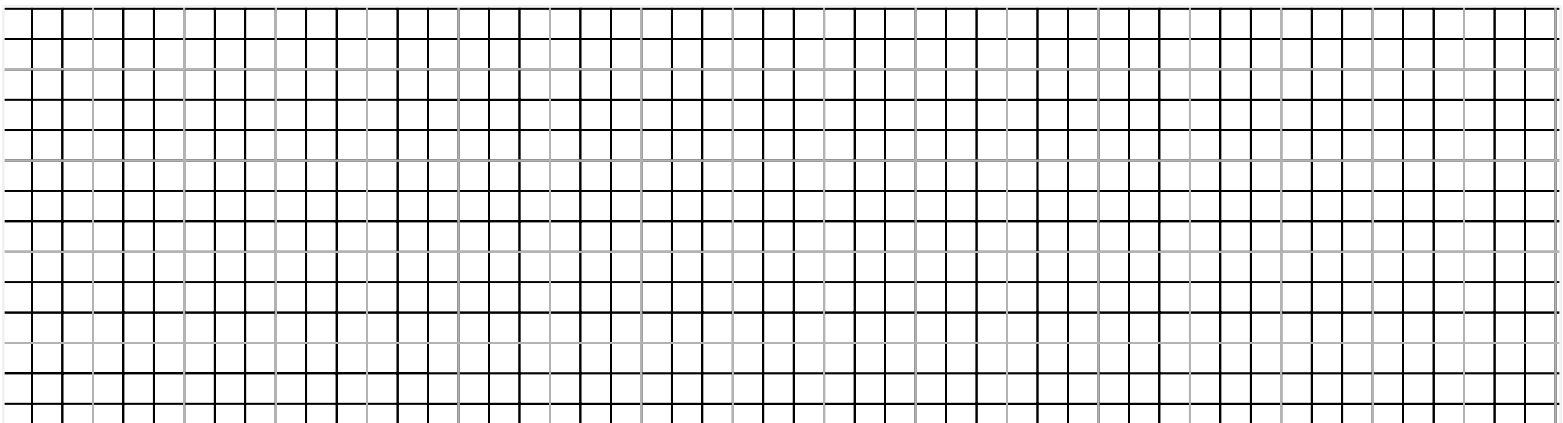

# Compatible Drivers

## DMX Drivers



Specifications	
Input Range: 100-277VAC	24V Constant Voltage Output, Class2
IP66 Waterproof design	Efficiency up to 89%
Downloads (Click cells for linked documents)	
<b>100W</b>	

# Compatible Products

Click on product names for more information.

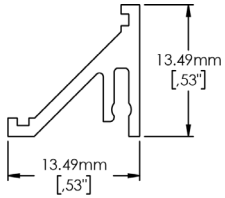

**CONNOR**

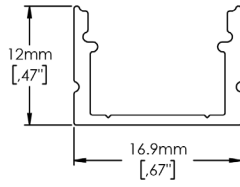

**DOBY**

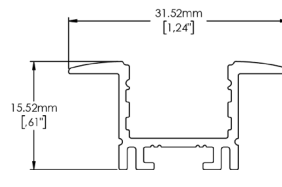

**JAXSON**

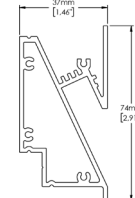

**MYLA**

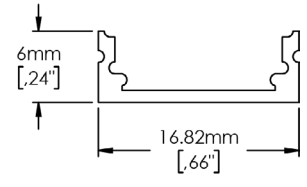

**OLIVIA**

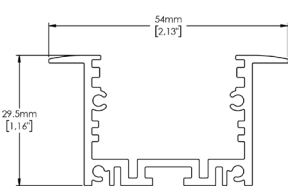

**PALAZO MASTER**

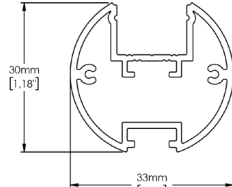

**POLA**

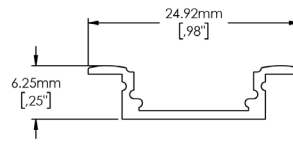

**ROBERTHA**

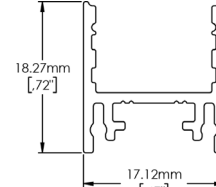

**ROCCO**

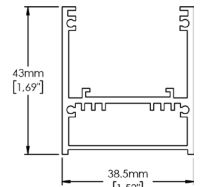

**VENGA**

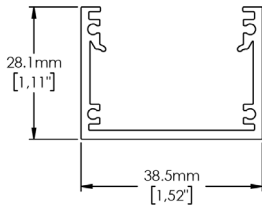

**VENGA SLIM**

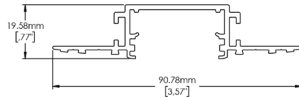

**VENGA SLIM TRIMLESS**

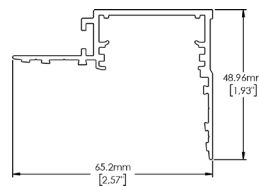

**VENGA SLIM TRIMLESS PERIMETER**

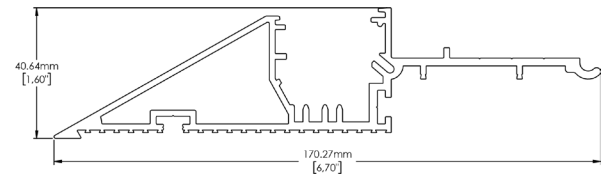

**ARKALUX**